

INTERIOR WALL SCHEDULE			
TAG	DESCRIPTION	INSULATION	NOTES
2-T-N	3 5/8" 20 GA STUDS @ 16" O.C.	NONE	TERMINATE 6" ABOVE CEILING. PROVIDE 45 DEGREE METAL STUD BRACING AT 48" O.C. FROM STUD WALL TO STRUCTURE ABOVE. SEE PLAN FOR WALL SHEATHING.
3-F-N	3 5/8" 20 GA STUDS @ 16" O.C.	NONE	FULL HT. WALL. SEE PLAN FOR WALL SHEATHING.

WALL SHEATHING KEY

SYMBOL	DESCRIPTION
▲	INDICATES SHEATHING TRANSITION
(A)	5/8" GYP. WALL BOARD (FULL WALL HEIGHT)
(B)	5/8" GYP. WALL BOARD (TERMINATE AT 6" (150MM) ABOVE CEILING)
(C)	5/8" CEMENTITIOUS BACKER BOARD (TERMINATE AT 6" (150MM) ABOVE CEILING)
(D)	5/8" CEMENTITIOUS BACKER BOARD (FULL WALL HEIGHT)
(E)	5/8" PLYWOOD (TERMINATE AT 6" (150MM) ABOVE CEILING)
(F)	5/8" GYP. WALL BOARD (FULL WALL HEIGHT)

WALL TYPES

NOTE: REFER TO FLOOR PLAN FOR WALL TYPES USED, SHEATHING, AND HEIGHT INFORMATION.

2 NEW FURRED/CHASE WALL

20 GA. 3 5/8" MTL STUDS 16" O.C. WITH 5/8" TYPE 'X' GWB ON ONE SIDE (5/8" TILE BACKER BOARD AS INDICATED ON RESTROOM / BACKBAR / DRIVE THRU SIDE) TO HEIGHT INDICATED ON FLOOR PLAN. SECURE SHEATHING TO STUDS WITH DRYWALL SCREWS @ 10" O.C. AT PANEL EDGES AND 12" O.C. AT INTERMEDIATE SUPPORTS.

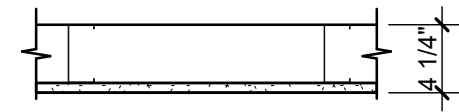

KEYED NOTES

- STRUCTURAL COLUMN. SEE STRUCTURAL.
- CONCRETE SLAB OVER VAPOR BARRIER OVER COMPACTED FILL. REFER TO STRUCTURAL.
- ELECTRICAL PANEL LOCATIONS. MAINTAIN MINIMUM CLEARANCE AS REQUIRED BY CODE.
- 36" CLEAR FOR ROOF LADDER ACCESS.
- OUTLINE OF CANOPY ABOVE. SEE ROOF PLAN AND EXTERIOR ELEVATIONS.
- RECESSED AREA FOR FUTURE WALK OFF MAT, TO BE COORDINATED WITH REGIONAL DESIGN TEAM. SEE STRUCTURAL.
- FUTURE FURRED PLUMBING WALL.
- FUTURE FURRED WALL.
- ROOF SCUPPER AND DOWNSPOUT. CONNECT VERTICAL LEADERS TO UNDERGROUND STORM DRAIN.
- CANOPY DOWNSPOUT. CONNECT VERTICAL LEADERS TO UNDERGROUND STORM DRAIN.
- SEE STRUCTURAL FOR HEADER ABOVE KNOCK-OUT. STANDARD FRAMING CAN INFILL BELOW HEADER. COORDINATE WITH REGIONAL DESIGN TEAM IF NEEDED.
- CURB BELOW ASSOCIATED WITH FURRING AND INSULATION.
- ALTERNATE EXTERIOR ROOF LADDER LOCATION
- DOOR ACTUATOR CONTROL PEDESTAL.
- WALL MOUNTED DOOR ACTUATOR CONTROL.
- DOOR ACTUATOR KEY SWITCH, WALL MOUNTED.
- DOOR OPERATOR LOCATED ABOVE KNOWN ACTIVE DOOR.

GENERAL NOTES

- GENERAL CONTRACTOR TO VERIFY ALL DIMENSIONS AND NOTIFY STARBUCKS CONSTRUCTION MANAGER OF ANY DISCREPANCIES PRIOR TO CONSTRUCTION. ALL DIMENSIONS TO BE TAKEN FROM DESIGNATED DATUM POINT.
- PROVIDE FIRE TREATED WOOD STUD BLOCKING, OR EQUIVALENT TO SUPPORT ANY WALL ATTACHMENT AND/OR SIGNAGE.
- INTERIOR DIMENSIONS ARE TO FINISHED FACE UNLESS SHOWN OR NOTED OTHERWISE.
- EXTERIOR WALL DIMENSIONS ARE TO FACE OF SHEATHING UNLESS SHOWN OR NOTED OTHERWISE.
- INSTALL MOISTURE RESISTANT DRYWALL ON BACKBAR WALL PER LLWL.
- ALL DOORS SHALL BE 32" (815MM) MINIMUM CLEAR OPENING WHEN OPENED TO 90 DEGREE POSITION UNLESS OTHERWISE NOTED.
- SEE DOOR AND WINDOW SHEET FOR EXTERIOR DOOR AND WINDOW SCHEDULES.
- DOOR HARDWARE COMPONENTS PROVIDED AND INSTALLED PER LLWL.
- PROVIDE FIRE EXTINGUISHERS AS NOTED ON THE APPROVED PLANS FROM THE CITY.
- SEE STRUCTURAL FOR KNEE WALL BRACING.
- SEE DETAIL SHEETS FOR BUILDING DETAILS.
- REFER TO FLOOR FINISH SHEET FOR FLOOR FINISHES.



STARBUCKS
2401 UTAH AVENUE SOUTH
SEATTLE, WASHINGTON 98134
(206) 318-1575

THESE DRAWINGS AND THE PROJECT MANUAL ARE CONFIDENTIAL AND SHALL REMAIN THE SOLE PROPERTY OF STARBUCKS CORPORATION, WHICH IS THE OWNER OF THE COPYRIGHT IN THIS WORK. THEY SHALL NOT BE REPRODUCED (IN WHOLE OR IN PART), SHARED WITH THIRD PARTIES OR USED IN ANY MANNER ON OTHER PROJECTS OR EXTENSIONS TO THIS PROJECT WITHOUT THE PRIOR WRITTEN CONSENT OF STARBUCKS CORPORATION. THESE DRAWINGS AND SPECIFICATIONS ARE INTENDED TO EXPRESS DESIGN INTENT FOR A PROTOTYPICAL STARBUCKS STORE (WHICH IS SUBJECT TO CHANGE AT ANYTIME) AND DO NOT REFLECT ACTUAL SITE CONDITIONS. NEITHER PARTY SHALL HAVE ANY OBLIGATION NOR LIABILITY TO THE OTHER (EXCEPT STATED ABOVE) UNTIL A WRITTEN AGREEMENT IS FULLY EXECUTED BY BOTH PARTIES.

STARBUCKS TEMPLATE VERSION: i2021.10.22

ARCHITECT OF RECORD

THIS DRAWING IS A DESIGN DEVELOPMENT DOCUMENT. SITE SPECIFIC MODIFICATIONS MADE UNDER THE RESPONSIBLE CHARGE OF THE ARCHITECT AND/OR ENGINEER-OF-RECORD WILL BE REQUIRED PRIOR TO USING THIS DOCUMENT FOR BIDDING, PERMITTING, OR CONSTRUCTION.

DESIGN DEVELOPMENT ONLY - NOT INTENDED FOR CONSTRUCTION USE

PROJECT NAME:
**STARBUCKS
PROTOTYPE_STB-A**

PROJECT ADDRESS:
1234 MAIN STREET
ANYWHERE, USA 99999

STORE #: TBD
PROJECT #: <XXXX-XXX>
ISSUE DATE: 11-29-2022
DESIGN MANAGER: STARBUCKS
PRODUCTION DESIGNER:
CHECKED BY:

Revision Schedule			
Rev	Date	By	Description

SHEET TITLE:
**BUILDING FLOOR
PLAN REMOTE**

SCALE: AS SHOWN

SHEET NUMBER:
A101R

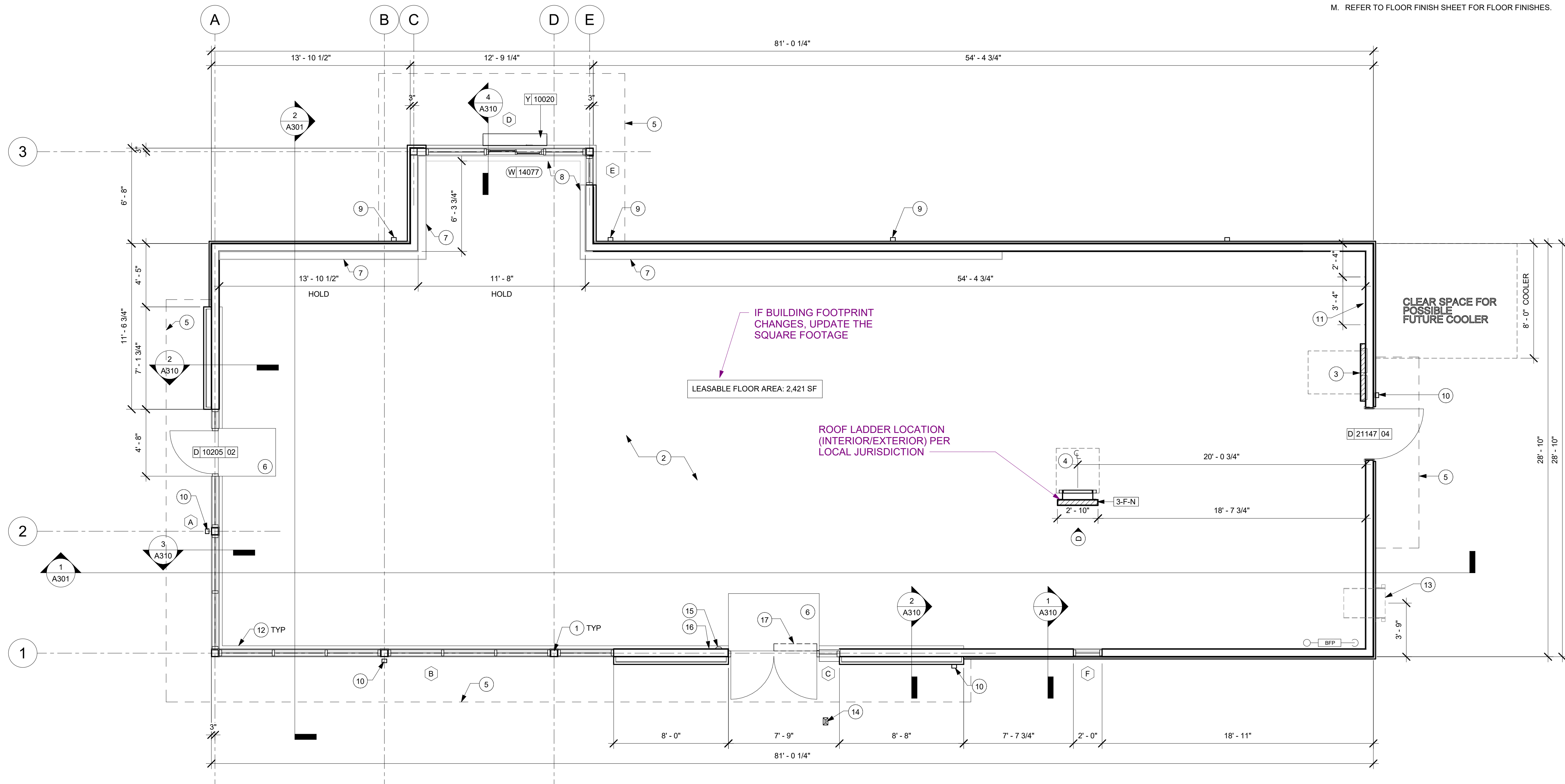

1 FLOOR PLAN_REMOTE
Scale: 1/4" = 1'-0"

EXTERIOR SIGNAGE SCHEDULE - "S"					
DESIGN ID	COUNT	DESCRIPTION	FURN. BY	INST. BY	COMMENTS
SIGNAGE - DISK					
13163	1	SIGN - DISK SF ILLUMINATED FLUSH MOUNTED EVOLVED - 48IN 1220MM	SB	SB	**
13182	1	SIGN - DISK SF ILLUMINATED FLUSH MOUNTED EVOLVED - 71IN 1805MM	SB	SB	**
SIGNAGE - DRIVE THRU					
x1600	2	6" PIN MOUNTED DRIVE-THRU SIGN LETTERS	SB	SB	**
SIGNAGE - WORDMARK					
18504	1	SIGN - WORDMARK STARBUCKS ON RACEWAY - 14IN 355MM	SB	SB	WHITE LETTERS**
22610	1	SIGN - WORDMARK BLADE SUSPENDED - HORIZONTAL - 30X10IN 760X255MM	SB	SB	**

**ELECTRICAL CONDUIT, JBOX AND WALL BLOCKING SHALL BE INSTALLED BY LL. COORDINATE LOCATION OF JBOX WITH STARBUCKS SIGNAGE VENDOR. SIGNAGE SHOWN FOR REFERENCE ONLY. SIGNAGE SHALL BE FURNISHED AND INSTALLED BY STARBUCKS SIGNAGE VENDOR.

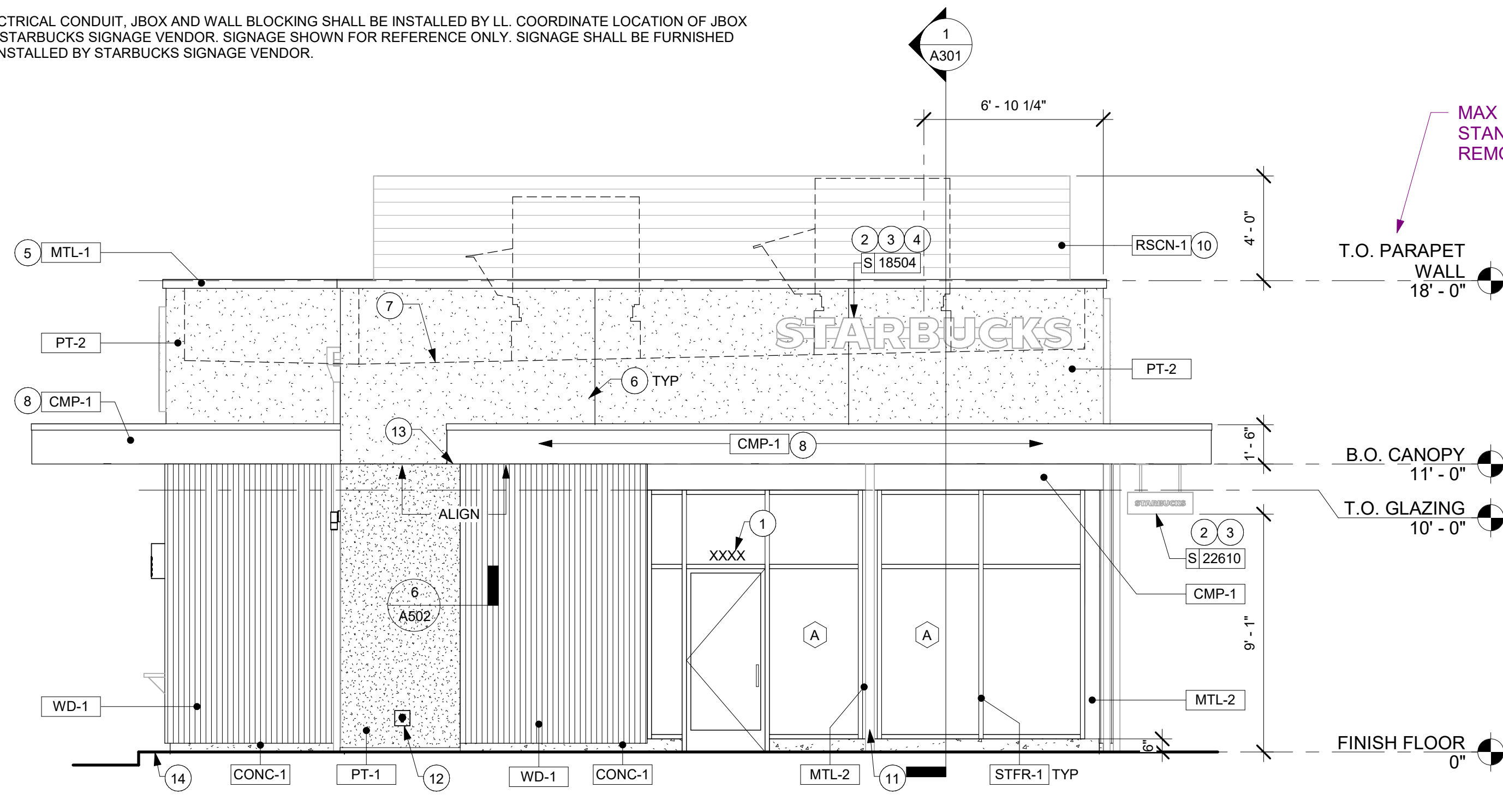

2 PATIO ENTRY WOOD/EIFS
Scale: 1/4" = 1'-0"

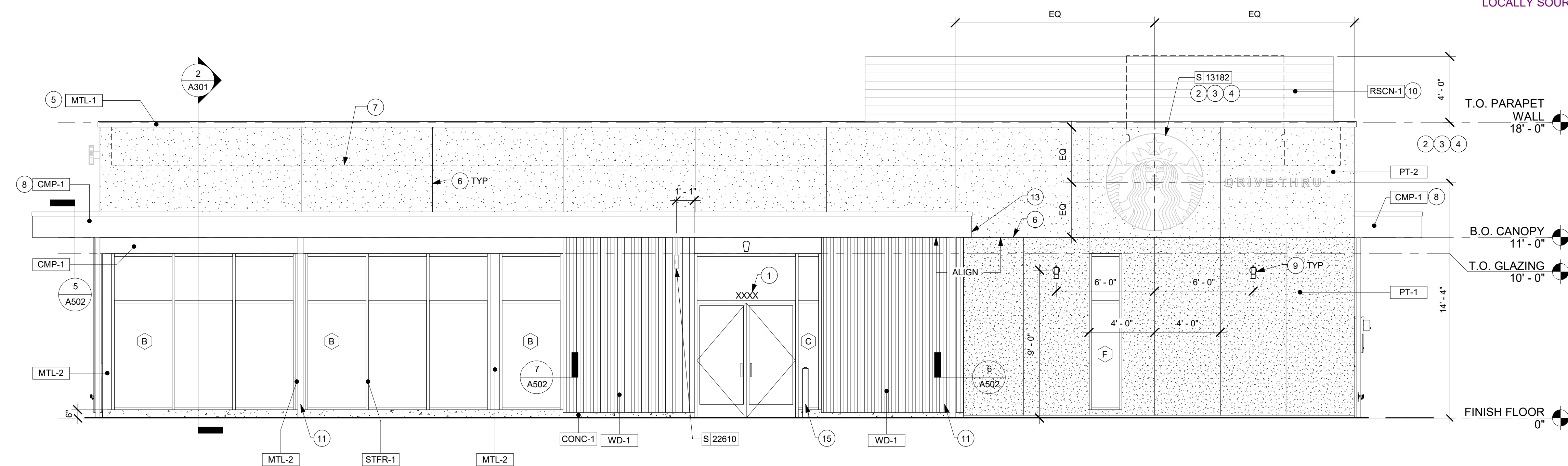

1 MAIN ENTRY WOOD/EIFS
Scale: 1/4" = 1'-0"

KEYED NOTES

- PROVIDE 3" HIGH BLACK ACRYLIC STORE ADDRESS ON GLAZING OR PER LOCAL JURISDICTIONAL CODE REQUIREMENTS.
- PROVIDE J-BOX FOR BUILDING SIGNAGE. COORDINATE LOCATION WITH SIGNAGE VENDOR SHOP DRAWINGS.
- PROVIDE SIGNAGE DISCONNECT ON INSIDE FACE OF WALL.
- 3/4" MARINE GRADE PLYWOOD BLOCKING FOR EXTERIOR SIGNAGE. EXTEND BLOCKING 8" MIN. BEYOND EDGE OF SIGNAGE.
- PRE-FINISHED METAL COPING, TYPICAL.
- EXTERIOR FINISH CONTROL JOINT.
- OUTLINE OF ROOF BEYOND.
- CANOPY. SEE BUILDING DETAIL SHEETS AND STRUCTURAL DRAWINGS.
- EXTERIOR SCOFF LIGHTING.
- ROOF EQUIPMENT SCREEN.
- DOWNSPOUT. CONNECT VERTICAL LEADERS TO UNDERGROUND STORM DRAIN. FINISH TO MATCH ADJACENT BUILDING FINISH.
- LOCKABLE HOSE BIBB.
- 6" CANOPY OVERHANG.
- DRIVE-THRU BUMP OUT TO BE LOCATED 12"-14" OFF THE FACE OF THE INSIDE CURB.
- DOOR ACTUATOR CONTROL PEDESTAL.

GENERAL NOTES

- GENERAL CONTRACTOR TO COORDINATE AND SCHEDULE SIGNAGE INSTALLATION WITH THE SIGNAGE CONTRACTOR PROVIDING A MINIMUM SCHEDULING NOTICE OF 4 WEEKS AND 1 WEEK PRIOR TO SCHEDULED DATE OF INSTALLATION. CONSTRUCTION MANAGER TO PROVIDE GENERAL CONTRACTOR WITH SIGNAGE CONTRACTOR CONTACT INFORMATION.
- GENERAL CONTRACTOR SHALL COORDINATE WITH ELECTRICAL CONTRACTOR TO FURNISH AND INSTALL ELECTRICAL CIRCUITS INCLUDING ALL CONDUIT, WIRE, CONNECTIONS AND BREAKER AT PANEL BOARD NECESSARY TO SERVE SIGNAGE.
- GENERAL CONTRACTOR TO PROVIDE FIRE TREATED WOOD STUD BLOCKING OR EQUIVALENT TO SUPPORT SIGNAGE.
- SIGNAGE CONTRACTOR SHALL VERIFY SIZE AND LOCATION OF ANY AND ALL ALLOWABLE MONUMENT OR POLE SIGNAGE AND PROVIDE SHOP DRAWING(S) PRIOR TO FABRICATION TO THE STARBUCKS DESIGNER FOR APPROVAL.
- SIGNAGE CONTRACTOR TO INSTALL SIGNAGE IN COMPLIANCE WITH LOCAL CODES AND OBTAIN PERMIT.
- SIGNAGE CONTRACTOR TO SUPPLY SHOP DRAWINGS TO CONSTRUCTION MANAGER AND TO THE GENERAL CONTRACTOR AS NEEDED. GENERAL CONTRACTOR TO NOTIFY CONSTRUCTION MANAGER IMMEDIATELY IF SHOP DRAWINGS OR INSTALLATION IS IN DISCREPANCY WITH ARCHITECTURAL DRAWINGS.
- SEE SHEET A602 FOR WINDOW AND DOOR TYPES.

MAX PARAPET HEIGHT IS 20'-0" FOR STANDARD FOOTPRINT. TBD FOR REMOTE MARKET FOOTPRINT.

MATERIALS SHOWN IN SCHEDULE ARE FOR EXTERIOR FINISH OPTION SHOWN ON THIS SHEET ONLY

ROOF SCREEN FINISH: BLACK OR AS SELECTED BY REGIONAL DESIGN TEAM

EXTERIOR FINISHES SCHEDULE - WOOD/EIFS		
FINISH CODE	DESCRIPTION	COMMENTS
CMP-1	COMPOSITE METAL PANELS	MATCH STOREFRONT
CONC-1	FINISHED CONCRETE	
MTL-1	PREFINISHED COPING	
MTL-2	METAL - PREFINISHED BRAKE METAL	MATCH STOREFRONT
PT-1	EIFS (COARSE)	STUCCO (ALTERNATE)
PT-2	EIFS	STUCCO (ALTERNATE)
RSCN-1	ROOF SCREEN PANEL	HORIZONTAL RIBBED PANEL BY ROOFSCREEN OR EQUAL
STFR-1	PREFINISHED ALUMINUM STOREFRONT (COLOR - MATTE BLACK)	4 1/2" THERMALLY BROKEN
WD-1	WOOD SIDING	

SITE ADAPT ARCHITECT TO REVIEW FINISHES W/ STARBUCKS DESIGN MANAGER AND LOCALLY SOURCE.



STARBUCKS
2401 UTAH AVENUE SOUTH
SEATTLE, WASHINGTON 98134
(206) 318-1575

THESE DRAWINGS AND THE PROJECT MANUAL ARE CONFIDENTIAL AND SHALL REMAIN THE SOLE PROPERTY OF STARBUCKS CORPORATION, WHICH IS THE OWNER OF THE COPYRIGHT IN THIS WORK. THEY SHALL NOT BE REPRODUCED (IN WHOLE OR IN PART), SHARED WITH THIRD PARTIES OR USED IN ANY MANNER ON OTHER PROJECTS OR EXTENSIONS TO THIS PROJECT WITHOUT THE PRIOR WRITTEN CONSENT OF STARBUCKS CORPORATION. THESE DRAWINGS AND SPECIFICATIONS ARE INTENDED TO EXPRESS DESIGN INTENT FOR A PROTOTYPICAL STARBUCKS STORE (WHICH IS SUBJECT TO CHANGE AT ANYTIME) AND DO NOT REFLECT ACTUAL SITE CONDITIONS. NEITHER PARTY SHALL HAVE ANY OBLIGATION NOR LIABILITY TO THE OTHER (EXCEPT STATED ABOVE) UNTIL A WRITTEN AGREEMENT IS FULLY EXECUTED BY BOTH PARTIES.

STARBUCKS TEMPLATE VERSION: i2021.10.22

ARCHITECT OF RECORD

THIS DRAWING IS A DESIGN DEVELOPMENT DOCUMENT. SITE SPECIFIC MODIFICATIONS MADE UNDER THE RESPONSIBLE CHARGE OF THE ARCHITECT AND/OR ENGINEER-OF-RECORD WILL BE REQUIRED PRIOR TO USING THIS DOCUMENT FOR BIDDING, PERMITTING, OR CONSTRUCTION.

PROJECT NAME:
**STARBUCKS
PROTOTYPE_STB-A**

PROJECT ADDRESS:
**1234 MAIN STREET
ANYWHERE, USA 99999**

STORE #: TBD
PROJECT #: <XXXXX-XXX>
ISSUE DATE: 11-29-2022
DESIGN MANAGER: STARBUCKS
PRODUCTION DESIGNER:
CHECKED BY:

Revision Schedule			
Rev	Date	By	Description

SHEET TITLE:
**EXTERIOR ELEVATIONS
- WOOD/EIFS**

SCALE: AS SHOWN

SHEET NUMBER:
A201

DESIGN DEVELOPMENT ONLY - NOT INTENDED FOR CONSTRUCTION USE

EXTERIOR SIGNAGE SCHEDULE - "S"					
DESIGN ID	COUNT	DESCRIPTION	FURN. BY	INST. BY	COMMENTS
SIGNAGE - DISK					
13163	1	SIGN - DISK SF ILLUMINATED FLUSH MOUNTED EVOLVED - 48IN 1220MM	SB	SB	**
13182	1	SIGN - DISK SF ILLUMINATED FLUSH MOUNTED EVOLVED - 71IN 1805MM	SB	SB	**
SIGNAGE - DRIVE THRU					
x1600	2	6" PIN MOUNTED DRIVE-THRU SIGN LETTERS	SB	SB	**
SIGNAGE - WORDMARK					
18504	1	SIGN - WORDMARK STARBUCKS ON RACEWAY - 14IN 355MM	SB	SB	WHITE LETTERS**
22610	1	SIGN - WORDMARK BLADE SUSPENDED - HORIZONTAL - 30X10IN 760X255MM	SB	SB	**

**ELECTRICAL CONDUIT, JBOX AND WALL BLOCKING SHALL BE INSTALLED BY LL. COORDINATE LOCATION OF JBOX WITH STARBUCKS SIGNAGE VENDOR. SIGNAGE SHOWN FOR REFERENCE ONLY. SIGNAGE SHALL BE FURNISHED AND INSTALLED BY STARBUCKS SIGNAGE VENDOR.

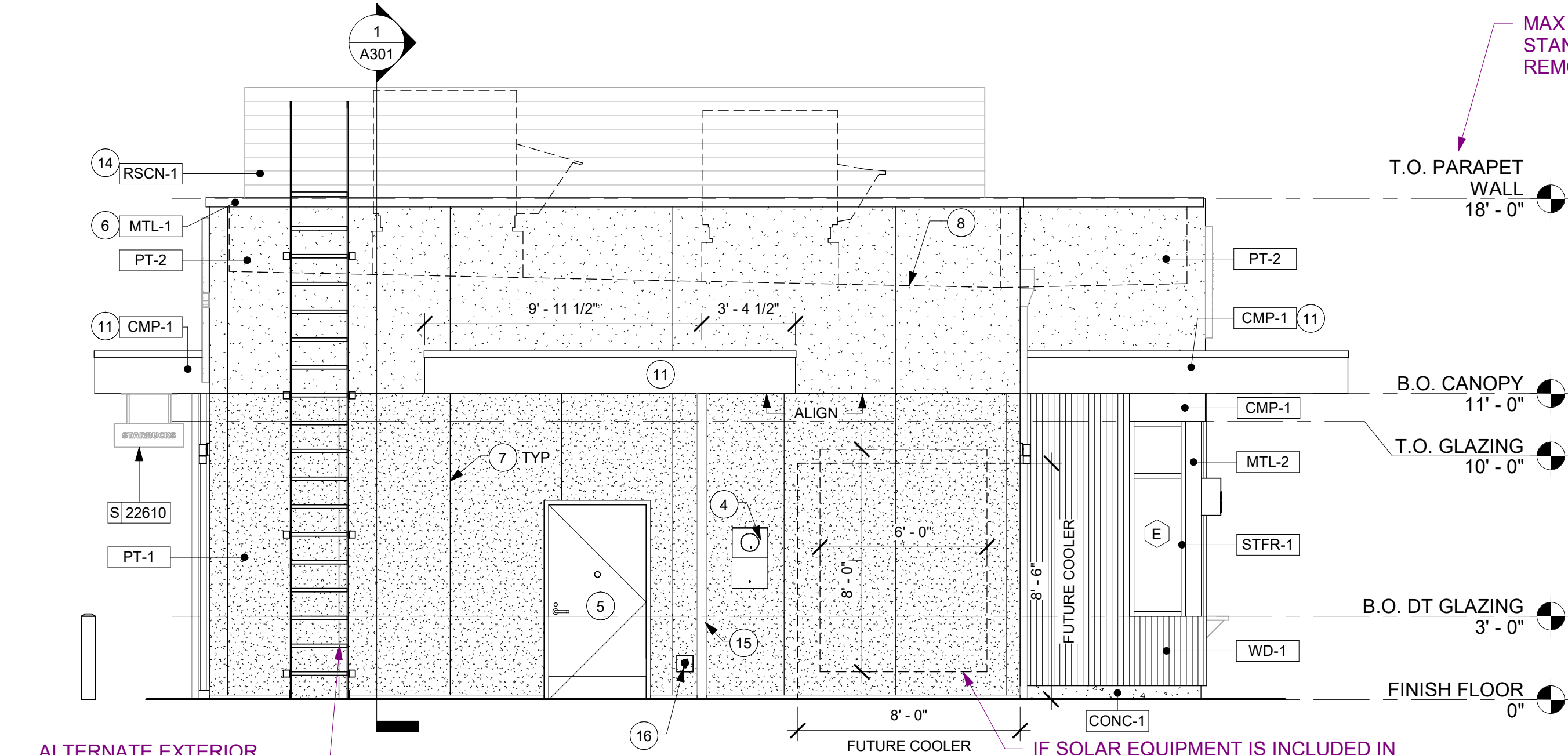

ALTERNATE EXTERIOR ROOF LADDER LOCATION

2 REAR SERVICE WOOD/EIFS
Scale: 1/4" = 1'-0"

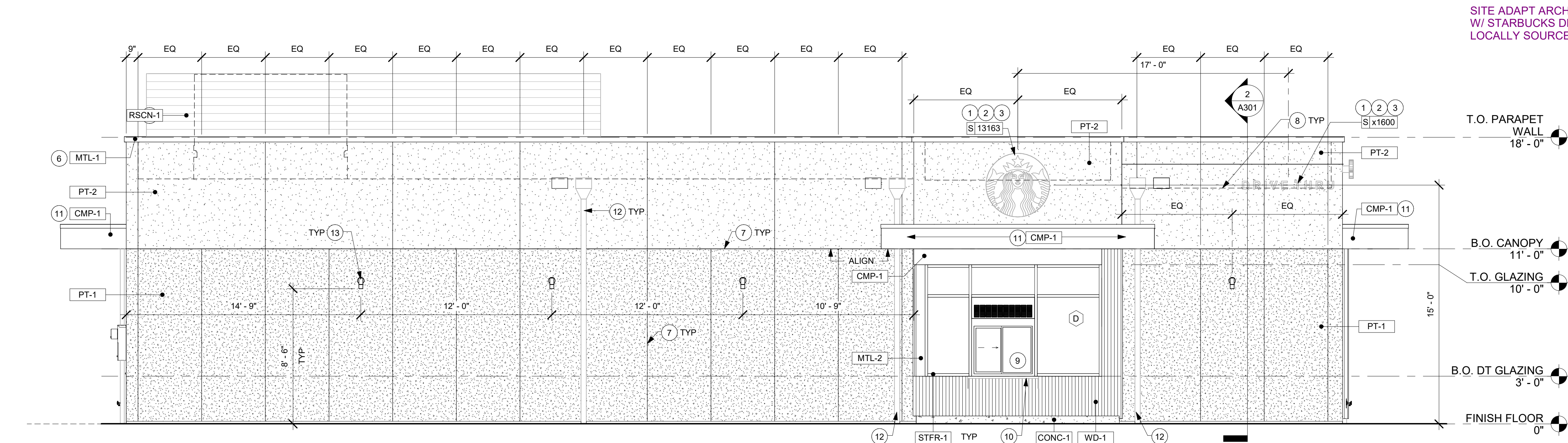

1 DRIVE THRU WOOD/EIFS
Scale: 1/4" = 1'-0"

KEYED NOTES

1. PROVIDE J-BOX FOR BUILDING SIGNAGE. COORDINATE LOCATION WITH SIGNAGE VENDOR SHOP DRAWINGS.
2. PROVIDE SIGNAGE DISCONNECT ON INSIDE FACE OF WALL.
3. 3/4" MARINE GRADE PLYWOOD BLOCKING FOR EXTERIOR SIGNAGE. EXTEND BLOCKING 8" (205MM) MIN. BEYOND EDGE OF SIGNAGE.
4. ELECTRICAL METER.
5. SERVICE DOOR.
6. PRE-FINISHED METAL COPING, TYPICAL.
7. EXTERIOR FINISH CONTROL JOINT.
8. OUTLINE OF ROOF BEYOND.
9. DT WINDOW. PROVIDE READY ACCESS DT SERVICE WINDOW. WINDOW AND AIR CURTAIN FINISH TO MATCH ADJACENT STOREFRONT.
10. DT WINDOW SHELF. INSTALL SERVICE WINDOW SHELF AT 36" INSIDE.
11. CANOPY. SEE BUILDING DETAIL SHEETS AND STRUCTURAL DRAWINGS.
12. ROOF SCUPPER AND DOWNSPOUT. CONNECT VERTICAL LEADERS TO UNDERGROUND STORM DRAIN.
13. EXTERIOR SCONCE LIGHTING.
14. ROOF EQUIPMENT SCREEN.
15. CANOPY DOWNSPOUT. CONNECT VERTICAL LEADERS TO UNDERGROUND STROM DRAIN.
16. LOCKABLE HOSE BIB.

GENERAL NOTES

- A. GENERAL CONTRACTOR TO COORDINATE AND SCHEDULE SIGNAGE INSTALLATION WITH THE SIGNAGE CONTRACTOR PROVIDING A MINIMUM SCHEDULING NOTICE OF 4 WEEKS AND 1 WEEK PRIOR TO SCHEDULED DATE OF INSTALLATION. CONSTRUCTION MANAGER TO PROVIDE GENERAL CONTRACTOR WITH SIGNAGE CONTRACTOR CONTACT INFORMATION.
- B. GENERAL CONTRACTOR SHALL COORDINATE WITH ELECTRICAL CONTRACTOR TO FURNISH AND INSTALL ELECTRICAL CIRCUITS INCLUDING ALL CONDUIT, WIRE, CONNECTIONS AND BREAKER AT PANEL BOARD NECESSARY TO SERVE SIGNAGE.
- C. GENERAL CONTRACTOR TO PROVIDE FIRE TREATED WOOD STUD BLOCKING OR EQUIVALENT TO SUPPORT SIGNAGE.
- D. SIGNAGE CONTRACTOR SHALL VERIFY SIZE AND LOCATION OF ANY AND ALL ALLOWABLE MONUMENT OR POLE SIGNAGE AND PROVIDE SHOP DRAWING(S) PRIOR TO FABRICATION TO THE STARBUCKS DESIGNER FOR APPROVAL.
- E. SIGNAGE CONTRACTOR TO INSTALL SIGNAGE IN COMPLIANCE WITH LOCAL CODES AND OBTAIN PERMIT.
- F. SIGNAGE CONTRACTOR TO SUPPLY SHOP DRAWINGS TO CONSTRUCTION MANAGER AND TO THE GENERAL CONTRACTOR AS NEEDED. GENERAL CONTRACTOR TO NOTIFY CONSTRUCTION MANAGER IMMEDIATELY IF SHOP DRAWINGS OR INSTALLATION IS IN DISCREPANCY WITH ARCHITECTURAL DRAWINGS.
- G. SEE SHEET A602 FOR WINDOW AND DOOR TYPES.

MAX PARAPET HEIGHT IS 20'-0" FOR STANDARD FOOTPRINT. TBD FOR REMOTE MARKET FOOTPRINT.

MATERIALS SHOWN IN SCHEDULE ARE FOR EXTERIOR FINISH OPTION SHOWN ON THIS SHEET ONLY

ROOF SCREEN FINISH: BLACK OR AS SELECTED BY REGIONAL DESIGN TEAM

EXTERIOR FINISHES SCHEDULE - WOOD/EIFS		
FINISH CODE	DESCRIPTION	COMMENTS
CMP-1	COMPOSITE METAL PANELS	MATCH STOREFRONT
CONC-1	FINISHED CONCRETE	
MTL-1	PREFINISHED COPING	
MTL-2	METAL - PREFINISHED BRAKE METAL	MATCH STOREFRONT
PT-1	EIFS (COARSE)	STUCCO (ALTERNATE)
PT-2	EIFS	STUCCO (ALTERNATE)
RSCN-1	ROOF SCREEN PANEL	HORIZONTAL RIBBED PANEL BY ROOFSCREEN OR EQUAL
STFR-1	PREFINISHED ALUMINUM STOREFRONT (COLOR - MATTE BLACK)	4 1/2" THERMALLY BROKEN
WD-1	WOOD SIDING	

SITE ADAPT ARCHITECT TO REVIEW FINISHES W/ STARBUCKS DESIGN MANAGER AND LOCALLY SOURCE.



STARBUCKS
2401 UTAH AVENUE SOUTH
SEATTLE, WASHINGTON 98134
(206) 318-1575

THESE DRAWINGS AND THE PROJECT MANUAL ARE CONFIDENTIAL AND SHALL REMAIN THE SOLE PROPERTY OF STARBUCKS CORPORATION, WHICH IS THE OWNER OF THE COPYRIGHT IN THIS WORK. THEY SHALL NOT BE REPRODUCED (IN WHOLE OR IN PART), SHARED WITH THIRD PARTIES OR USED IN ANY MANNER ON OTHER PROJECTS OR EXTENSIONS TO THIS PROJECT WITHOUT THE PRIOR WRITTEN CONSENT OF STARBUCKS CORPORATION. THESE DRAWINGS AND SPECIFICATIONS ARE INTENDED TO EXPRESS DESIGN INTENT FOR A PROTOTYPICAL STARBUCKS STORE (WHICH IS SUBJECT TO CHANGE AT ANYTIME) AND DO NOT REFLECT ACTUAL SITE CONDITIONS. NEITHER PARTY SHALL HAVE ANY OBLIGATION NOR LIABILITY TO THE OTHER (EXCEPT STATED ABOVE) UNTIL A WRITTEN AGREEMENT IS FULLY EXECUTED BY BOTH PARTIES.

STARBUCKS TEMPLATE VERSION: i2021.10.22

ARCHITECT OF RECORD

THIS DRAWING IS A DESIGN DEVELOPMENT DOCUMENT. SITE SPECIFIC MODIFICATIONS MADE UNDER THE RESPONSIBLE CHARGE OF THE ARCHITECT AND/OR ENGINEER-OF-RECORD WILL BE REQUIRED PRIOR TO USING THIS DOCUMENT FOR BIDDING, PERMITTING, OR CONSTRUCTION.

PROJECT NAME:
**STARBUCKS
PROTOTYPE_STB-A**

PROJECT ADDRESS:
1234 MAIN STREET
ANYWHERE, USA 99999

STORE #: TBD
PROJECT #: <XXXXX-XXX>
ISSUE DATE: 11-29-2022
DESIGN MANAGER: STARBUCKS
PRODUCTION DESIGNER:
CHECKED BY:

Revision Schedule			
Rev	Date	By	Description

SHEET TITLE:
**EXTERIOR ELEVATIONS
- WOOD/EIFS**
SCALE: AS SHOWN

SHEET NUMBER:
A202

DESIGN DEVELOPMENT ONLY - NOT INTENDED FOR CONSTRUCTION USE

EXTERIOR SIGNAGE SCHEDULE - "S"					
DESIGN ID	COUNT	DESCRIPTION	FURN. BY	INST. BY	COMMENTS
SIGNAGE - DISK					
13163	1	SIGN - DISK SF ILLUMINATED FLUSH MOUNTED EVOLVED - 48IN 1220MM	SB	SB	**
13182	1	SIGN - DISK SF ILLUMINATED FLUSH MOUNTED EVOLVED - 71IN 1805MM	SB	SB	**
SIGNAGE - DRIVE THRU					
x1600	2	6" PIN MOUNTED DRIVE-THRU SIGN LETTERS	SB	SB	**
SIGNAGE - WORDMARK					
18504	1	SIGN - WORDMARK STARBUCKS ON RACEWAY - 14IN 355MM	SB	SB	WHITE LETTERS**
22610	1	SIGN - WORDMARK BLADE SUSPENDED - HORIZONTAL - 30X10IN 760X255MM	SB	SB	**

**ELECTRICAL CONDUIT, JBOX AND WALL BLOCKING SHALL BE INSTALLED BY LL. COORDINATE LOCATION OF JBOX WITH STARBUCKS SIGNAGE VENDOR. SIGNAGE SHOWN FOR REFERENCE ONLY. SIGNAGE SHALL BE FURNISHED AND INSTALLED BY STARBUCKS SIGNAGE VENDOR.

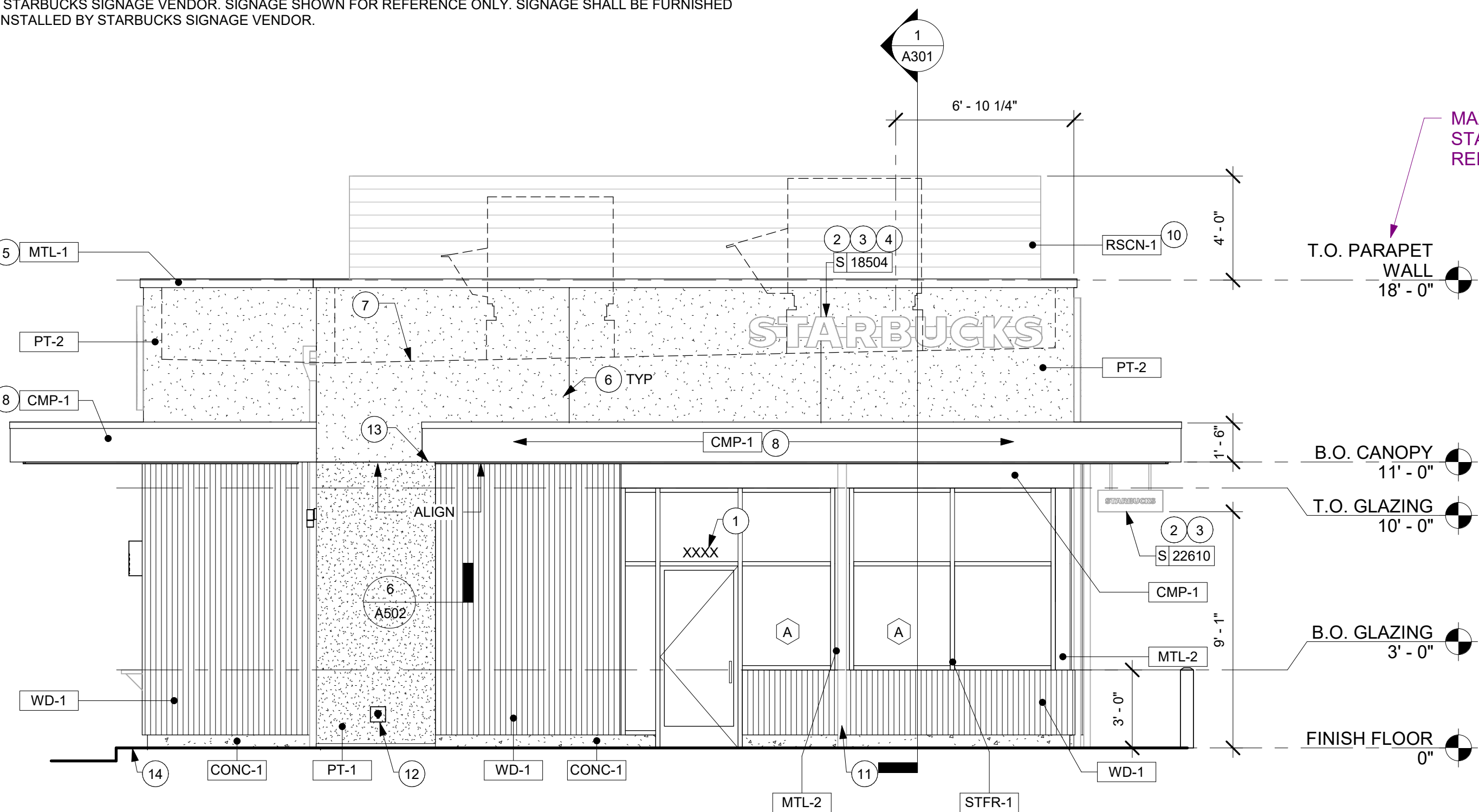

2 PATIO ENTRY_WOOD/EIFS

Scale: 1/4" = 1'-0"

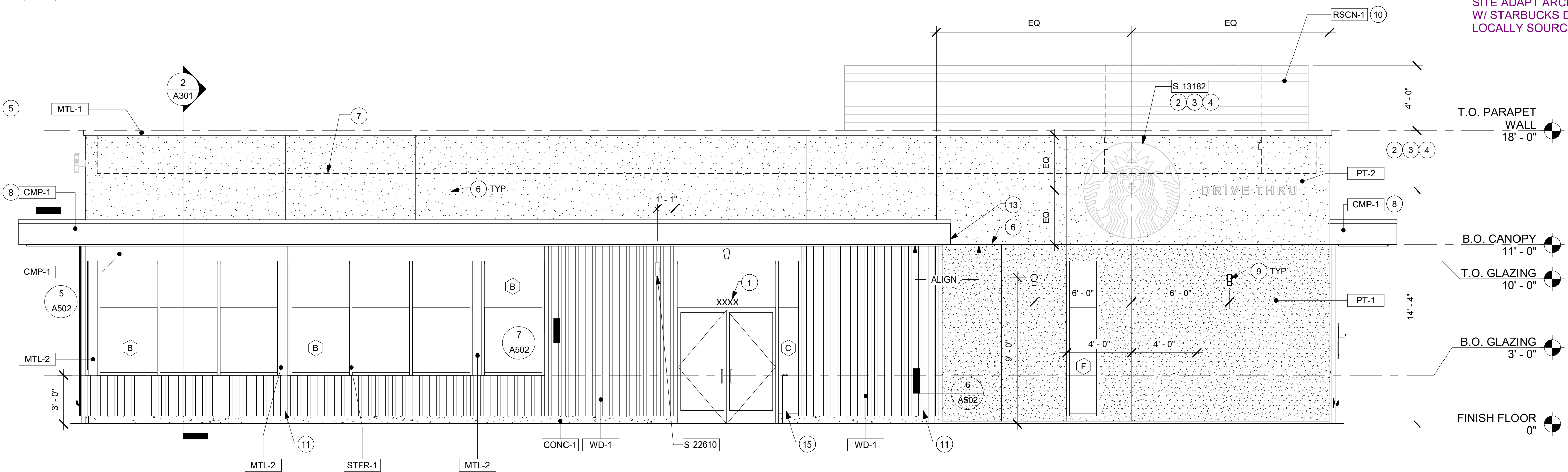

1 MAIN ENTRY_WOOD/EIFS

Scale: 1/4" = 1'-0"

KEYED NOTES

- PROVIDE 3" HIGH BLACK ACRYLIC STORE ADDRESS ON GLAZING OR PER LOCAL JURISDICTIONAL CODE REQUIREMENTS.
- PROVIDE J-BOX FOR BUILDING SIGNAGE. COORDINATE LOCATION WITH SIGNAGE VENDOR SHOP DRAWINGS.
- PROVIDE SIGNAGE DISCONNECT ON INSIDE FACE OF WALL.
- 3/4" MARINE GRADE PLYWOOD BLOCKING FOR EXTERIOR SIGNAGE. EXTEND BLOCKING 8" MIN. BEYOND EDGE OF SIGNAGE.
- PRE-FINISHED METAL COPING, TYPICAL.
- EXTERIOR FINISH CONTROL JOINT.
- OUTLINE OF ROOF BEYOND.
- CANOPY. SEE BUILDING DETAIL SHEETS AND STRUCTURAL DRAWINGS.
- EXTERIOR SCIENCE LIGHTING.
- ROOF EQUIPMENT SCREEN
- DOWNSPOUT. CONNECT VERTICAL LEADERS TO UNDERGROUND STORM DRAIN. FINISH TO MATCH ADJACENT BUILDING FINISH.
- LOCKABLE HOSE BIBB.
- 6" CANOPY OVERHANG.
- DRIVE-THRU BUMP OUT TO BE LOCATED 12"-14" OFF THE FACE OF THE INSIDE CURB.
- DOOR ACTUATOR CONTROL PEDESTAL.

GENERAL NOTES

- GENERAL CONTRACTOR TO COORDINATE AND SCHEDULE SIGNAGE INSTALLATION WITH THE SIGNAGE CONTRACTOR PROVIDING A MINIMUM SCHEDULING NOTICE OF 4 WEEKS AND 1 WEEK PRIOR TO SCHEDULED DATE OF INSTALLATION. CONSTRUCTION MANAGER TO PROVIDE GENERAL CONTRACTOR WITH SIGNAGE CONTRACTOR CONTACT INFORMATION.
- GENERAL CONTRACTOR SHALL COORDINATE WITH ELECTRICAL CONTRACTOR TO FURNISH AND INSTALL ELECTRICAL CIRCUITS INCLUDING ALL CONDUIT, WIRE, CONNECTIONS AND BREAKER AT PANEL BOARD NECESSARY TO SERVE SIGNAGE.
- GENERAL CONTRACTOR TO PROVIDE FIRE TREATED WOOD STUD BLOCKING OR EQUIVALENT TO SUPPORT SIGNAGE.
- SIGNAGE CONTRACTOR SHALL VERIFY SIZE AND LOCATION OF ANY AND ALL ALLOWABLE MONUMENT OR POLE SIGNAGE AND PROVIDE SHOP DRAWING(S) PRIOR TO FABRICATION TO THE STARBUCKS DESIGNER FOR APPROVAL.
- SIGNAGE CONTRACTOR TO INSTALL SIGNAGE IN COMPLIANCE WITH LOCAL CODES AND OBTAIN PERMIT.
- SIGNAGE CONTRACTOR TO SUPPLY SHOP DRAWINGS TO CONSTRUCTION MANAGER AND TO THE GENERAL CONTRACTOR AS NEEDED. GENERAL CONTRACTOR TO NOTIFY CONSTRUCTION MANAGER IMMEDIATELY IF SHOP DRAWINGS OR INSTALLATION IS IN DISCREPANCY WITH ARCHITECTURAL DRAWINGS.
- SEE SHEET A602 FOR WINDOW AND DOOR TYPES.

MAX PARAPET HEIGHT IS 20'-0" FOR STANDARD FOOTPRINT. TBD FOR REMOTE MARKET FOOTPRINT.

MATERIALS SHOWN IN SCHEDULE ARE FOR EXTERIOR FINISH OPTION SHOWN ON THIS SHEET ONLY

ROOF SCREEN FINISH: BLACK OR AS SELECTED BY REGIONAL DESIGN TEAM

EXTERIOR FINISHES SCHEDULE - WOOD/EIFS		
FINISH CODE	DESCRIPTION	COMMENTS
CMP-1	COMPOSITE METAL PANELS	MATCH STOREFRONT
CONC-1	FINISHED CONCRETE	
MTL-1	PREFINISHED COPING	
MTL-2	METAL - PREFINISHED BRAKE METAL	MATCH STOREFRONT
PT-1	EIFS (COARSE)	STUCCO (ALTERNATE)
PT-2	EIFS	STUCCO (ALTERNATE)
RSCN-1	ROOF SCREEN PANEL	HORIZONTAL RIBBED PANEL BY ROOFSCREEN OR EQUAL
STFR-1	PREFINISHED ALUMINUM STOREFRONT (COLOR - MATTE BLACK)	4 1/2" THERMALLY BROKEN
WD-1	WOOD SIDING	

SITE ADAPT ARCHITECT TO REVIEW FINISHES W/ STARBUCKS DESIGN MANAGER AND LOCALLY SOURCE.



STARBUCKS
2401 UTAH AVENUE SOUTH
SEATTLE, WASHINGTON 98134
(206) 318-1575

THESE DRAWINGS AND THE PROJECT MANUAL ARE CONFIDENTIAL AND SHALL REMAIN THE SOLE PROPERTY OF STARBUCKS CORPORATION, WHICH IS THE OWNER OF THE COPYRIGHT IN THIS WORK. THEY SHALL NOT BE REPRODUCED (IN WHOLE OR IN PART), SHARED WITH THIRD PARTIES OR USED IN ANY MANNER ON OTHER PROJECTS OR EXTENSIONS TO THIS PROJECT WITHOUT THE PRIOR WRITTEN CONSENT OF STARBUCKS CORPORATION. THESE DRAWINGS AND SPECIFICATIONS ARE INTENDED TO EXPRESS DESIGN INTENT FOR A PROTOTYPICAL STARBUCKS STORE (WHICH IS SUBJECT TO CHANGE AT ANYTIME) AND DO NOT REFLECT ACTUAL SITE CONDITIONS. NEITHER PARTY SHALL HAVE ANY OBLIGATION NOR LIABILITY TO THE OTHER (EXCEPT STATED ABOVE) UNTIL A WRITTEN AGREEMENT IS FULLY EXECUTED BY BOTH PARTIES.

STARBUCKS TEMPLATE VERSION: i2021.10.22

ARCHITECT OF RECORD

THIS DRAWING IS A DESIGN DEVELOPMENT DOCUMENT. SITE SPECIFIC MODIFICATIONS MADE UNDER THE RESPONSIBLE CHARGE OF THE ARCHITECT AND/OR ENGINEER-OF-RECORD WILL BE REQUIRED PRIOR TO USING THIS DOCUMENT FOR BIDDING, PERMITTING, OR CONSTRUCTION.

PROJECT NAME:
**STARBUCKS
PROTOTYPE_STB-A**

PROJECT ADDRESS:
1234 MAIN STREET
ANYWHERE, USA 99999

STORE #: TBD
PROJECT #: <XXXX-XXX>
ISSUE DATE: 11-29-2022
DESIGN MANAGER: STARBUCKS
PRODUCTION DESIGNER:
CHECKED BY:

Revision Schedule			
Rev	Date	By	Description

SHEET TITLE:
**EXTERIOR ELEVATIONS
- KNEE WALL**
SCALE: AS SHOWN

SHEET NUMBER:
A203

DESIGN DEVELOPMENT ONLY - NOT INTENDED FOR CONSTRUCTION USE