



Massachusetts Department of Environmental Protection
Bureau of Resource Protection - Wetlands

Fairhaven
City/Town

WPA Form 1- Request for Determination of Applicability

Massachusetts Wetlands Protection Act M.G.L. c. 131, §40

A. General Information

Important:

When filling out forms on the computer, use only the tab key to move your cursor - do not use the return key.

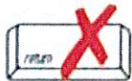

1. Applicant:

CHANDA KALE

chandaKale@yahoo.com

Name

E-Mail Address

5495 POST ROAD

Mailing Address

CHARLESTOWN

RI

02813

City/Town

State

Zip Code

0178813048

Phone Number

Fax Number (if applicable)

2. Representative (if any):

Firm

Contact Name

E-Mail Address

Mailing Address

City/Town

State

Zip Code

Phone Number

Fax Number (if applicable)

B. Determinations

1. I request the FAIRHAVEN Conservation Commission make the following determination(s). Check any that apply:

- ☐ a. whether the **area** depicted on plan(s) and/or map(s) referenced below is an area subject to jurisdiction of the Wetlands Protection Act.
- ☐ b. whether the **boundaries** of resource area(s) depicted on plan(s) and/or map(s) referenced below are accurately delineated.
- ☐ c. whether the **work** depicted on plan(s) referenced below is subject to the Wetlands Protection Act.
- ☒ d. whether the area and/or work depicted on plan(s) referenced below is subject to the jurisdiction of any **municipal wetlands ordinance** or **bylaw** of:

FAIRHAVEN

Name of Municipality

- ☐ e. whether the following **scope of alternatives** is adequate for work in the Riverfront Area as depicted on referenced plan(s).



WPA Form 1- Request for Determination of Applicability
Massachusetts Wetlands Protection Act M.G.L. c. 131, §40

C. Project Description

1. a. Project Location (use maps and plans to identify the location of the area subject to this request):

23 GOWLART MEMORIAL DRIVE FAIRHAVEN MA 02719
Street Address

42
Assessors Map/Plat Number

22B
City/Town
Parcel/Lot Number

- b. Area Description (use additional paper, if necessary):

DUNE AREA bordering Access Road and parking Area
on my property

- c. Plan and/or Map Reference(s):

SITE MAP
Title

May 1st 2023
Date

Title

Date

Title

Date

2. a. Work Description (use additional paper and/or provide plan(s) of work, if necessary):

EROSION control by planting native plants
such as Rosa Rugosa and Juniper along the edge
of the dune and further protecting dune by
placing a dune fence.



Massachusetts Department of Environmental Protection
Bureau of Resource Protection - Wetlands

City/Town _____

WPA Form 1- Request for Determination of Applicability

Massachusetts Wetlands Protection Act M.G.L. c. 131, §40

C. Project Description (cont.)

b. Identify provisions of the Wetlands Protection Act or regulations which may exempt the applicant from having to file a Notice of Intent for all or part of the described work (use additional paper, if necessary).

3. a. If this application is a Request for Determination of Scope of Alternatives for work in the Riverfront Area, indicate the one classification below that best describes the project.

- ☒ Single family house on a lot recorded on or before 8/1/96
- ☐ Single family house on a lot recorded after 8/1/96
- ☐ Expansion of an existing structure on a lot recorded after 8/1/96
- ☐ Project, other than a single family house or public project, where the applicant owned the lot before 8/7/96
- ☐ New agriculture or aquaculture project
- ☐ Public project where funds were appropriated prior to 8/7/96
- ☐ Project on a lot shown on an approved, definitive subdivision plan where there is a recorded deed restriction limiting total alteration of the Riverfront Area for the entire subdivision
- ☐ Residential subdivision; institutional, industrial, or commercial project
- ☐ Municipal project
- ☐ District, county, state, or federal government project
- ☐ Project required to evaluate off-site alternatives in more than one municipality in an Environmental Impact Report under MEPA or in an alternatives analysis pursuant to an application for a 404 permit from the U.S. Army Corps of Engineers or 401 Water Quality Certification from the Department of Environmental Protection.

b. Provide evidence (e.g., record of date subdivision lot was recorded) supporting the classification above (use additional paper and/or attach appropriate documents, if necessary.)



Massachusetts Department of Environmental Protection
Bureau of Resource Protection - Wetlands

City/Town _____

WPA Form 1- Request for Determination of Applicability

Massachusetts Wetlands Protection Act M.G.L. c. 131, §40

D. Signatures and Submittal Requirements

I hereby certify under the penalties of perjury that the foregoing Request for Determination of Applicability and accompanying plans, documents, and supporting data are true and complete to the best of my knowledge.

I further certify that the property owner, if different from the applicant, and the appropriate DEP Regional Office were sent a complete copy of this Request (including all appropriate documentation) simultaneously with the submittal of this Request to the Conservation Commission.

Failure by the applicant to send copies in a timely manner may result in dismissal of the Request for Determination of Applicability.

Name and address of the property owner:

CHANDA KAU
Name
23 GOUKART MEMORIAL DRIVE
Mailing Address
FAIRHAVEN MA 02719
City/Town
State Zip Code

Signatures:

I also understand that notification of this Request will be placed in a local newspaper at my expense in accordance with Section 10.05(3)(b)(1) of the Wetlands Protection Act regulations.

Signature of Applicant
Date 4/13/2023

Signature of Representative (if any) Date

Dune fence
Plants Rosa Rubra and Juniper

Plants as depicted on the plant; Also prior to it, repositioning displace sand on Access Road, on the dune.

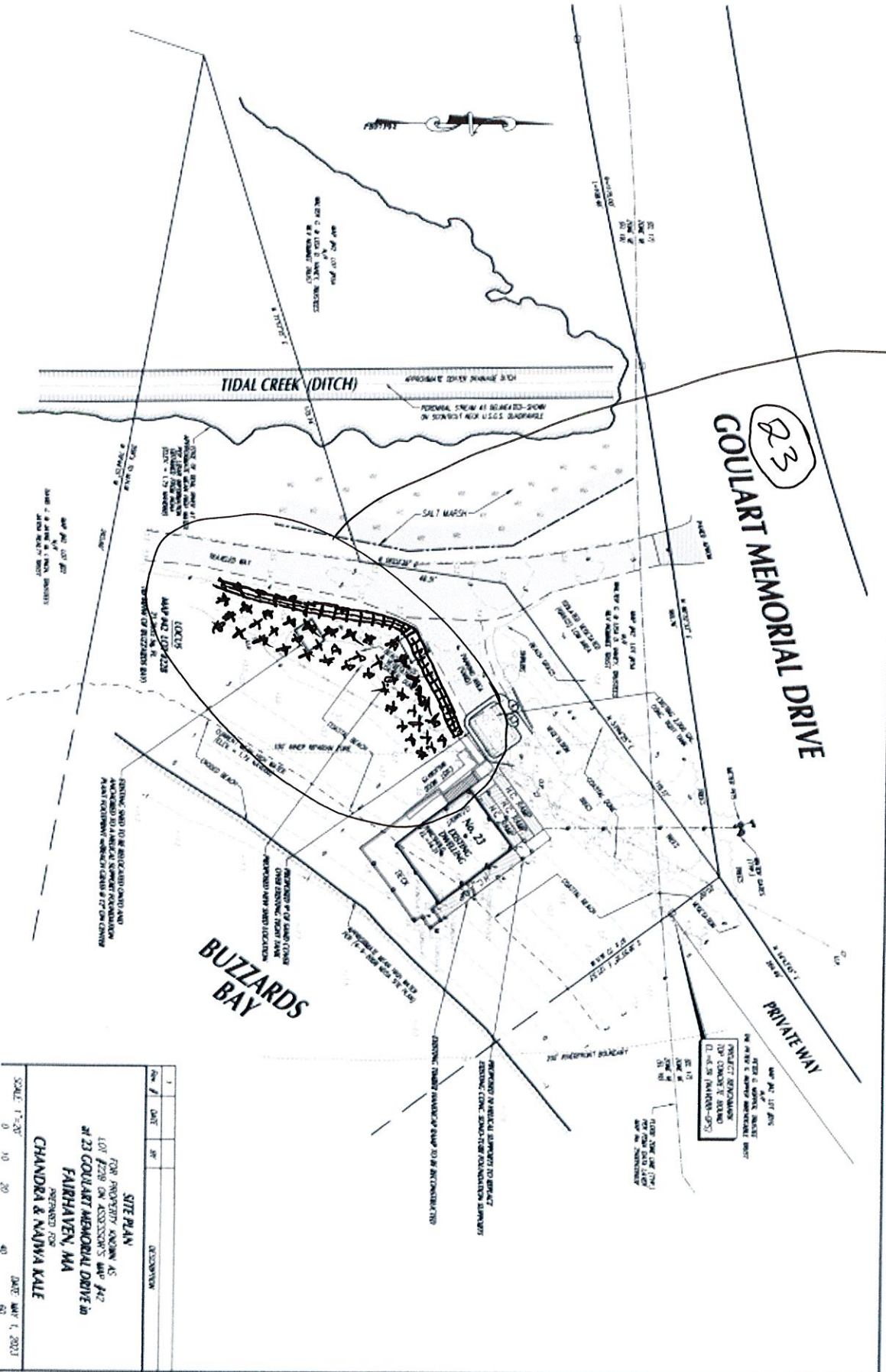



04/12/2024

10:34:36 AM

Fairhaven

GIS - Abutters

Sorted By: Parcel ID

23 Goulart Memorial Dr 100 Ft

Parcel ID - Map/Block/Lot	Location	Owner/Mailing Address
42-015A	839 SCOTICUT NECK RD Fairhaven, MA 02719	VAHEY WALTER G & LISA 2 WARE RD WINCHESTER, MA 01890
42-015B	GOULART MEMORIAL DR Fairhaven, MA 02719	LONGDEN JO-ANN P 111 BRIDGE STREET FAIRHAVEN, MA 02719
42-021F	27 GOULART MEMORIAL DR Fairhaven, MA 02719	MANZONE RONALD J & ALFONSE ANNE MARIE 179 ACUSHNET ROAD MATTAPoisETT, MA 02739
42-021G	GOULART MEMORIAL DR Fairhaven, MA 02719	NOPPER PETER G TTE 12 LAMBETH PARK DRIVE FAIRHAVEN, MA 02719
42-022	21 GOULART MEMORIAL DR Fairhaven, MA 02719	LYNCH DAVID J & JAYNE M 21 GOULART MEMORIAL DR FAIRHAVEN, MA 02719
42-022B	23 GOULART MEMORIAL DR Fairhaven, MA 02719	KALE CHANDA & NAJWA 5495 POST ROAD CHARLESTOWN, RI 02813

**Notification to Abutters Under the
Massachusetts Wetlands Protection Act
and the Fairhaven Wetlands Bylaw**

*(this form must be completed and copies sent by certified mail
or hand delivery to all abutters within 100 feet of the property
where the project is located)*

In accordance with the Massachusetts General Laws Chapter 131, Section 40 (the Wetlands Protection Act) and the Fairhaven Wetlands Bylaw (Chapter 192), you are hereby notified of the following:

1. The applicant's name is CHANDA KALE
2. The applicant has filed the following with the Fairhaven Conservation Commission:
☒ Request for Determination of Applicability
☒ Notice of Intent
☐ Request to Amend an existing Order of Conditions
☐ Notice of Resource Area Delineation
3. The address or location of the site where the activity, project, or delineation is proposed is:
23 GOULART MEMORIAL DRIVE, Fairhaven, MA.
4. The proposed work includes PLANTING NATIVE PLANTS SUCH AS JUNIPER AND ROSA REGUSA
ALONG THE DUNE TO PREVEN FURTHER EROSION. ALSO PLACE DUNE
FENCE ALONG THE PLANTS.
5. Copies of the above application may be examined at the Conservation Office, located in Town Hall, 40 Center Street, Fairhaven, MA 02719, between 9:00 AM and 4:00 PM, Monday through Friday. Copies may be obtained at the office if notified in advance or from the applicant.
6. Applications will also be uploaded to www.fairhaven-ma.gov/conservation-commission/pages/current-filings. If you are unable to access or view the application electronically, please contact the Conservation Office at 508-979-4023, ext. 128.
7. Notice of the public hearing including its date, time, and place will be published at least five business days in advance in the Fairhaven Neighborhood News, and will be posted on the Fairhaven Town Website and at the Fairhaven Town Hall not less than 48 hours in advance.

PLEASE NOTE:

Since you are receiving this notice, you may have wetland resource areas or wetland buffers on your property. Therefore, construction, cutting, clearing, or grading may require a permit. For clarification or for more information, call the Conservation Agent at 508-979-4082 or visit our website.