



Massachusetts Department of Environmental Protection
Bureau of Resource Protection - Wetlands

Provided by MassDEP:

WPA Form 3 – Notice of Intent

Massachusetts Wetlands Protection Act M.G.L. c. 131, §40

MassDEP File Number

Document Transaction Number

City/Town

Important:
When filling out forms on the computer, use only the tab key to move your cursor - do not use the return key.



Note:
Before completing this form consult your local Conservation Commission regarding any municipal bylaw or ordinance.

A. General Information

1. Project Location (**Note:** electronic filers will click on button to locate project site):

27 Nakata Ave Fairhaven 02719
a. Street Address b. City/Town c. Zip Code
Latitude and Longitude: 41.5890849 70.8529420
d. Latitude e. Longitude
43 120
f. Assessors Map/Plat Number g. Parcel /Lot Number

2. Applicant:

Katie Medeiros
a. First Name b. Last Name
c. Organization
27 Nakata Ave
d. Street Address
Fairhaven MA 02719
e. City/Town f. State g. Zip Code
774-328-1929 oceanskatie@gmail.com
h. Phone Number i. Fax Number j. Email Address

3. Property owner (required if different from applicant): Check if more than one owner

a. First Name b. Last Name
c. Organization
d. Street Address
e. City/Town f. State g. Zip Code
h. Phone Number i. Fax Number j. Email address

4. Representative (if any):

a. First Name b. Last Name
c. Company
d. Street Address
e. City/Town f. State g. Zip Code
h. Phone Number i. Fax Number j. Email address

5. Total WPA Fee Paid (from NOI Wetland Fee Transmittal Form):

\$100.00 \$42.50 \$67.50
a. Total Fee Paid b. State Fee Paid c. City/Town Fee Paid



Massachusetts Department of Environmental Protection
Bureau of Resource Protection - Wetlands

Provided by MassDEP:

MassDEP File Number

Document Transaction Number

City/Town

WPA Form 3 – Notice of Intent

Massachusetts Wetlands Protection Act M.G.L. c. 131, §40

A. General Information (continued)

6. General Project Description: *retroactive application for concrete repair patch on patio, replace existing deck, restore grass area of yard to grade, convert driveway to crushed shell, install 75ft of shadowbox style fence, repair 50ft of existing post and beam fence*

7a. Project Type Checklist: (Limited Project Types see Section A. 7b.)

- 1. Single Family Home
- 2. Residential Subdivision
- 3. Commercial/Industrial
- 4. Dock/Pier
- 5. Utilities
- 6. Coastal engineering Structure
- 7. Agriculture (e.g., cranberries, forestry)
- 8. Transportation
- 9. Other

7b. Is any portion of the proposed activity eligible to be treated as a limited project (including Ecological Restoration Limited Project) subject to 310 CMR 10.24 (coastal) or 310 CMR 10.53 (inland)?

- 1. Yes No If yes, describe which limited project applies to this project. (See 310 CMR 10.24 and 10.53 for a complete list and description of limited project types)

2. Limited Project Type

If the proposed activity is eligible to be treated as an Ecological Restoration Limited Project (310 CMR10.24(8), 310 CMR 10.53(4)), complete and attach Appendix A: Ecological Restoration Limited Project Checklist and Signed Certification.

8. Property recorded at the Registry of Deeds for:

<i>Bristol</i>	
a. County	b. Certificate # (if registered land)
<i>4113</i>	<i>46</i>
c. Book	d. Page Number

B. Buffer Zone & Resource Area Impacts (temporary & permanent)

- 1. Buffer Zone Only – Check if the project is located only in the Buffer Zone of a Bordering Vegetated Wetland, Inland Bank, or Coastal Resource Area.
- 2. Inland Resource Areas (see 310 CMR 10.54-10.58; if not applicable, go to Section B.3, Coastal Resource Areas).

Check all that apply below. Attach narrative and any supporting documentation describing how the project will meet all performance standards for each of the resource areas altered, including standards requiring consideration of alternative project design or location.



Massachusetts Department of Environmental Protection
 Bureau of Resource Protection - Wetlands
WPA Form 3 – Notice of Intent
 Massachusetts Wetlands Protection Act M.G.L. c. 131, §40

Provided by MassDEP:

 MassDEP File Number

 Document Transaction Number

 City/Town

B. Buffer Zone & Resource Area Impacts (temporary & permanent) (cont'd)

For all projects affecting other Resource Areas, please attach a narrative explaining how the resource area was delineated.

<u>Resource Area</u>	<u>Size of Proposed Alteration</u>	<u>Proposed Replacement (if any)</u>
a. <input type="checkbox"/> Bank	1. linear feet _____	2. linear feet _____
b. <input type="checkbox"/> Bordering Vegetated Wetland	1. square feet _____	2. square feet _____
c. <input type="checkbox"/> Land Under Waterbodies and Waterways	1. square feet _____	2. square feet _____
	3. cubic yards dredged _____	

<u>Resource Area</u>	<u>Size of Proposed Alteration</u>	<u>Proposed Replacement (if any)</u>
d. <input type="checkbox"/> Bordering Land Subject to Flooding	1. square feet _____	2. square feet _____
	3. cubic feet of flood storage lost _____	4. cubic feet replaced _____
e. <input type="checkbox"/> Isolated Land Subject to Flooding	1. square feet _____	
	2. cubic feet of flood storage lost _____	3. cubic feet replaced _____

f. Riverfront Area

1. Name of Waterway (if available) - **specify coastal or inland** _____

2. Width of Riverfront Area (check one):

25 ft. - Designated Densely Developed Areas only

100 ft. - New agricultural projects only

200 ft. - All other projects

3. Total area of Riverfront Area on the site of the proposed project: _____ square feet

4. Proposed alteration of the Riverfront Area:

a. total square feet _____ b. square feet within 100 ft. _____ c. square feet between 100 ft. and 200 ft. _____

5. Has an alternatives analysis been done and is it attached to this NOI? Yes No

6. Was the lot where the activity is proposed created prior to August 1, 1996? Yes No

3. Coastal Resource Areas: (See 310 CMR 10.25-10.35)

Note: for coastal riverfront areas, please complete **Section B.2.f.** above.



Massachusetts Department of Environmental Protection
 Bureau of Resource Protection - Wetlands
WPA Form 3 – Notice of Intent
 Massachusetts Wetlands Protection Act M.G.L. c. 131, §40

Provided by MassDEP:

 MassDEP File Number

 Document Transaction Number

 City/Town

B. Buffer Zone & Resource Area Impacts (temporary & permanent) (cont'd)

Check all that apply below. Attach narrative and supporting documentation describing how the project will meet all performance standards for each of the resource areas altered, including standards requiring consideration of alternative project design or location.

Online Users:
 Include your document transaction number (provided on your receipt page) with all supplementary information you submit to the Department.

<u>Resource Area</u>	<u>Size of Proposed Alteration</u>	<u>Proposed Replacement (if any)</u>
a. <input type="checkbox"/> Designated Port Areas	Indicate size under Land Under the Ocean, below	
b. <input type="checkbox"/> Land Under the Ocean	_____	
	1. square feet	

	2. cubic yards dredged	
c. <input type="checkbox"/> Barrier Beach	Indicate size under Coastal Beaches and/or Coastal Dunes below	
d. <input type="checkbox"/> Coastal Beaches	_____	_____
	1. square feet	2. cubic yards beach nourishment
e. <input type="checkbox"/> Coastal Dunes	_____	_____
	1. square feet	2. cubic yards dune nourishment

	<u>Size of Proposed Alteration</u>	<u>Proposed Replacement (if any)</u>
f. <input type="checkbox"/> Coastal Banks	_____	
	1. linear feet	
g. <input type="checkbox"/> Rocky Intertidal Shores	_____	
	1. square feet	
h. <input type="checkbox"/> Salt Marshes	_____	_____
	1. square feet	2. sq ft restoration, rehab., creation
i. <input type="checkbox"/> Land Under Salt Ponds	_____	
	1. square feet	

	2. cubic yards dredged	
j. <input type="checkbox"/> Land Containing Shellfish	_____	
	1. square feet	
k. <input type="checkbox"/> Fish Runs	Indicate size under Coastal Banks, inland Bank, Land Under the Ocean, and/or inland Land Under Waterbodies and Waterways, above	

	1. cubic yards dredged	
l. <input checked="" type="checkbox"/> Land Subject to Coastal Storm Flowage	_____	
	200 sq. ft	
	1. square feet	

4. Restoration/Enhancement
 If the project is for the purpose of restoring or enhancing a wetland resource area in addition to the square footage that has been entered in Section B.2.b or B.3.h above, please enter the additional amount here.

_____ a. square feet of BVW _____ b. square feet of Salt Marsh

5. Project Involves Stream Crossings

_____ a. number of new stream crossings _____ b. number of replacement stream crossings

Massachusetts Department of Environmental Protection

Bureau of Resource Protection - Wetlands

WPA Form 3 – Notice of Intent

Massachusetts Wetlands Protection Act M.G.L. c. 131, §40

Provided by MassDEP:

MassDEP File Number _____

Document Transaction Number _____

City/Town _____

C. Other Applicable Standards and Requirements

- This is a proposal for an Ecological Restoration Limited Project. Skip Section C and complete Appendix A: Ecological Restoration Limited Project Checklists – Required Actions (310 CMR 10.11).

Streamlined Massachusetts Endangered Species Act/Wetlands Protection Act Review

1. Is any portion of the proposed project located in **Estimated Habitat of Rare Wildlife** as indicated on the most recent Estimated Habitat Map of State-Listed Rare Wetland Wildlife published by the Natural Heritage and Endangered Species Program (NHESP)? To view habitat maps, see the *Massachusetts Natural Heritage Atlas* or go to http://maps.massgis.state.ma.us/PRI_EST_HAB/viewer.htm.

- a. Yes No **If yes, include proof of mailing or hand delivery of NOI to:**

**Natural Heritage and Endangered Species Program
 Division of Fisheries and Wildlife
 1 Rabbit Hill Road
 Westborough, MA 01581**

- b. Date of map online 2024

If yes, the project is also subject to Massachusetts Endangered Species Act (MESA) review (321 CMR 10.18). To qualify for a streamlined, 30-day, MESA/Wetlands Protection Act review, please complete Section C.1.c, and include requested materials with this Notice of Intent (NOI); *OR* complete Section C.2.f, if applicable. *If MESA supplemental information is not included with the NOI, by completing Section 1 of this form, the NHESP will require a separate MESA filing which may take up to 90 days to review (unless noted exceptions in Section 2 apply, see below).*

- c. Submit Supplemental Information for Endangered Species Review*

1. Percentage/acreage of property to be altered:
- (a) within wetland Resource Area _____ percentage/acreage
- (b) outside Resource Area _____ percentage/acreage
2. Assessor's Map or right-of-way plan of site
2. Project plans for entire project site, including wetland resource areas and areas outside of wetlands jurisdiction, showing existing and proposed conditions, existing and proposed tree/vegetation clearing line, and clearly demarcated limits of work **
- (a) Project description (including description of impacts outside of wetland resource area & buffer zone)
- (b) Photographs representative of the site

* Some projects **not** in Estimated Habitat may be located in Priority Habitat, and require NHESP review (see <https://www.mass.gov/mass-endangered-species-act-mesa-regulatory-review>).

Priority Habitat includes habitat for state-listed plants and strictly upland species not protected by the Wetlands Protection Act.

** MESA projects may not be segmented (321 CMR 10.16). The applicant must disclose full development plans even if such plans are not required as part of the Notice of Intent process.



Massachusetts Department of Environmental Protection
 Bureau of Resource Protection - Wetlands
WPA Form 3 – Notice of Intent
 Massachusetts Wetlands Protection Act M.G.L. c. 131, §40

Provided by MassDEP:

MassDEP File Number

Document Transaction Number

City/Town

C. Other Applicable Standards and Requirements (cont'd)

- (c) MESA filing fee (fee information available at <https://www.mass.gov/how-to/how-to-file-for-a-mesa-project-review>).
 Make check payable to "Commonwealth of Massachusetts - NHESP" and **mail to NHESP** at above address

Projects altering 10 or more acres of land, also submit:

- (d) Vegetation cover type map of site
- (e) Project plans showing Priority & Estimated Habitat boundaries
- (f) OR Check One of the Following
1. Project is exempt from MESA review.
 Attach applicant letter indicating which MESA exemption applies. (See 321 CMR 10.14, <https://www.mass.gov/service-details/exemptions-from-review-for-projectsactivities-in-priority-habitat>; the NOI must still be sent to NHESP if the project is within estimated habitat pursuant to 310 CMR 10.37 and 10.59.)
 2. Separate MESA review ongoing. a. NHESP Tracking # _____ b. Date submitted to NHESP _____
 3. Separate MESA review completed.
 Include copy of NHESP "no Take" determination or valid Conservation & Management Permit with approved plan.
3. For coastal projects only, is any portion of the proposed project located below the mean high water line or in a fish run?
- a. Not applicable – project is in inland resource area only b. Yes No

If yes, include proof of mailing, hand delivery, or electronic delivery of NOI to either:

South Shore - Bourne to Rhode Island border, and
 the Cape & Islands:

Division of Marine Fisheries -
 Southeast Marine Fisheries Station
 Attn: Environmental Reviewer
 836 South Rodney French Blvd.
 New Bedford, MA 02744
 Email: dmf.envreview-south@mass.gov

North Shore - Plymouth to New Hampshire border:

Division of Marine Fisheries -
 North Shore Office
 Attn: Environmental Reviewer
 30 Emerson Avenue
 Gloucester, MA 01930
 Email: dmf.envreview-north@mass.gov

Also if yes, the project may require a Chapter 91 license. For coastal towns in the Northeast Region, please contact MassDEP's Boston Office. For coastal towns in the Southeast Region, please contact MassDEP's Southeast Regional Office.

- c. Is this an aquaculture project? d. Yes No

If yes, include a copy of the Division of Marine Fisheries Certification Letter (M.G.L. c. 130, § 57).



Massachusetts Department of Environmental Protection
Bureau of Resource Protection - Wetlands

Provided by MassDEP:

MassDEP File Number

Document Transaction Number

City/Town

WPA Form 3 – Notice of Intent

Massachusetts Wetlands Protection Act M.G.L. c. 131, §40

C. Other Applicable Standards and Requirements (cont'd)

Online Users:
Include your document transaction number (provided on your receipt page) with all supplementary information you submit to the Department.

4. Is any portion of the proposed project within an Area of Critical Environmental Concern (ACEC)?
- a. Yes No If yes, provide name of ACEC (see instructions to WPA Form 3 or MassDEP Website for ACEC locations). **Note:** electronic filers click on Website.
- b. ACEC _____
5. Is any portion of the proposed project within an area designated as an Outstanding Resource Water (ORW) as designated in the Massachusetts Surface Water Quality Standards, 314 CMR 4.00?
- a. Yes No
6. Is any portion of the site subject to a Wetlands Restriction Order under the Inland Wetlands Restriction Act (M.G.L. c. 131, § 40A) or the Coastal Wetlands Restriction Act (M.G.L. c. 130, § 105)?
- a. Yes No
7. Is this project subject to provisions of the MassDEP Stormwater Management Standards?
- a. Yes. Attach a copy of the Stormwater Report as required by the Stormwater Management Standards per 310 CMR 10.05(6)(k)-(q) and check if:
1. Applying for Low Impact Development (LID) site design credits (as described in Stormwater Management Handbook Vol. 2, Chapter 3)
 2. A portion of the site constitutes redevelopment
 3. Proprietary BMPs are included in the Stormwater Management System.
- b. No. Check why the project is exempt:
1. Single-family house
 2. Emergency road repair
 3. Small Residential Subdivision (less than or equal to 4 single-family houses or less than or equal to 4 units in multi-family housing project) with no discharge to Critical Areas.

D. Additional Information

- This is a proposal for an Ecological Restoration Limited Project. Skip Section D and complete Appendix A: Ecological Restoration Notice of Intent – Minimum Required Documents (310 CMR 10.12).

Applicants must include the following with this Notice of Intent (NOI). See instructions for details.

Online Users: Attach the document transaction number (provided on your receipt page) for any of the following information you submit to the Department.

1. USGS or other map of the area (along with a narrative description, if necessary) containing sufficient information for the Conservation Commission and the Department to locate the site. (Electronic filers may omit this item.)
2. Plans identifying the location of proposed activities (including activities proposed to serve as a Bordering Vegetated Wetland [BVW] replication area or other mitigating measure) relative to the boundaries of each affected resource area.



Massachusetts Department of Environmental Protection
 Bureau of Resource Protection - Wetlands
WPA Form 3 – Notice of Intent
 Massachusetts Wetlands Protection Act M.G.L. c. 131, §40

Provided by MassDEP:

 MassDEP File Number

 Document Transaction Number

 City/Town

D. Additional Information (cont'd)

- 3. Identify the method for BVW and other resource area boundary delineations (MassDEP BVW Field Data Form(s), Determination of Applicability, Order of Resource Area Delineation, etc.), and attach documentation of the methodology.
- 4. List the titles and dates for all plans and other materials submitted with this NOI.
 - a. Plan Title Plan to accompany Notice of Intent
 - b. Prepared By Katie Medeiros
 - c. Signed and Stamped by Katie Medeiros
 - d. Final Revision Date 04-03-24
 - e. Scale N/A
 - f. Additional Plan or Document Title Plan for NOI Application
 - g. Date 04-09-24
- 5. If there is more than one property owner, please attach a list of these property owners not listed on this form.
- 6. Attach proof of mailing for Natural Heritage and Endangered Species Program, if needed.
- 7. Attach proof of mailing for Massachusetts Division of Marine Fisheries, if needed.
- 8. Attach NOI Wetland Fee Transmittal Form
- 9. Attach Stormwater Report, if needed.

E. Fees

- 1. Fee Exempt: No filing fee shall be assessed for projects of any city, town, county, or district of the Commonwealth, federally recognized Indian tribe housing authority, municipal housing authority, or the Massachusetts Bay Transportation Authority.

Applicants must submit the following information (in addition to pages 1 and 2 of the NOI Wetland Fee Transmittal Form) to confirm fee payment:

2. Municipal Check Number <u>104</u>	3. Check date <u>04/03/24</u>
4. State Check Number <u>103</u>	5. Check date <u>04/03/24</u>
6. Payor name on check: First Name <u>Katie</u>	7. Payor name on check: Last Name <u>Medeiros</u>



Massachusetts Department of Environmental Protection
Bureau of Resource Protection - Wetlands

WPA Form 3 – Notice of Intent

Massachusetts Wetlands Protection Act M.G.L. c. 131, §40

Provided by MassDEP:

MassDEP File Number

Document Transaction Number

City/Town

F. Signatures and Submittal Requirements

I hereby certify under the penalties of perjury that the foregoing Notice of Intent and accompanying plans, documents, and supporting data are true and complete to the best of my knowledge. I understand that the Conservation Commission will place notification of this Notice in a local newspaper at the expense of the applicant in accordance with the wetlands regulations, 310 CMR 10.05(5)(a).

I further certify under penalties of perjury that all abutters were notified of this application, pursuant to the requirements of M.G.L. c. 131, § 40. Notice must be made by Certificate of Mailing or in writing by hand delivery or certified mail (return receipt requested) to all abutters within 100 feet of the property line of the project location.

Katie Medeiros
1. Signature of Applicant

04/03/24
2. Date

3. Signature of Property Owner (if different)

4. Date

5. Signature of Representative (if any)

6. Date

For Conservation Commission:

Two copies of the completed Notice of Intent (Form 3), including supporting plans and documents, two copies of the NOI Wetland Fee Transmittal Form, and the city/town fee payment, to the Conservation Commission by certified mail or hand delivery.

For MassDEP:

One copy of the completed Notice of Intent (Form 3), including supporting plans and documents, one copy of the NOI Wetland Fee Transmittal Form, and a **copy** of the state fee payment to the MassDEP Regional Office (see Instructions) by certified mail or hand delivery.

Other:

If the applicant has checked the "yes" box in any part of Section C, Item 3, above, refer to that section and the Instructions for additional submittal requirements.

The original and copies must be sent simultaneously. Failure by the applicant to send copies in a timely manner may result in dismissal of the Notice of Intent.

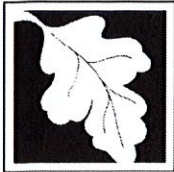

Massachusetts Department of Environmental Protection
 Bureau of Resource Protection - Wetlands
NOI Wetland Fee Transmittal Form
 Massachusetts Wetlands Protection Act M.G.L. c. 131, §40

Important: When filling out forms on the computer, use only the tab key to move your cursor - do not use the return key.



A. Applicant Information

1. Location of Project:

_____ 27 Nakata Ave _____ Fairhaven
 a. Street Address b. City/Town
 _____ 103 _____ \$42.50
 c. Check number d. Fee amount

2. Applicant Mailing Address:

_____ Katie _____ Medeiros
 a. First Name b. Last Name

 c. Organization
 _____ 27 Nakata Ave _____
 d. Mailing Address
 _____ Fairhaven _____ MA _____ 02719
 e. City/Town f. State g. Zip Code
 _____ 774-328-1929 _____ oceanskatie@gmail.com
 h. Phone Number i. Fax Number j. Email Address

3. Property Owner (if different):

_____ _____
 a. First Name b. Last Name

 c. Organization

 d. Mailing Address
 _____ _____ _____
 e. City/Town f. State g. Zip Code
 _____ _____ _____
 h. Phone Number i. Fax Number j. Email Address

To calculate filing fees, refer to the category fee list and examples in the instructions for filling out WPA Form 3 (Notice of Intent).

B. Fees

Fee should be calculated using the following process & worksheet. **Please see Instructions before filling out worksheet.**

Step 1/Type of Activity: Describe each type of activity that will occur in wetland resource area and buffer zone.

Step 2/Number of Activities: Identify the number of each type of activity.

Step 3/Individual Activity Fee: Identify each activity fee from the six project categories listed in the instructions.

Step 4/Subtotal Activity Fee: Multiply the number of activities (identified in Step 2) times the fee per category (identified in Step 3) to reach a subtotal fee amount. Note: If any of these activities are in a Riverfront Area in addition to another Resource Area or the Buffer Zone, the fee per activity should be multiplied by 1.5 and then added to the subtotal amount.

Step 5/Total Project Fee: Determine the total project fee by adding the subtotal amounts from Step 4.

Step 6/Fee Payments: To calculate the state share of the fee, divide the total fee in half and subtract \$12.50. To calculate the city/town share of the fee, divide the total fee in half and add \$12.50.



Massachusetts Department of Environmental Protection
 Bureau of Resource Protection - Wetlands
NOI Wetland Fee Transmittal Form
 Massachusetts Wetlands Protection Act M.G.L. c. 131, §40

B. Fees (continued)

Step 1/Type of Activity	Step 2/Number of Activities	Step 3/Individual Activity Fee	Step 4/Subtotal Activity Fee
Category 1 A. Work on single family lot	1	\$110.00	\$110.00

Step 5/Total Project Fee: _____

Step 6/Fee Payments:

Total Project Fee: \$110.00
 a. Total Fee from Step 5

State share of filing Fee: \$42.50
 b. 1/2 Total Fee less \$12.50

City/Town share of filling Fee: \$67.50
 c. 1/2 Total Fee plus \$12.50

C. Submittal Requirements

- a.) Complete pages 1 and 2 and send with a check or money order for the state share of the fee, payable to the Commonwealth of Massachusetts.

Department of Environmental Protection
 Box 4062
 Boston, MA 02211

- b.) **To the Conservation Commission:** Send the Notice of Intent or Abbreviated Notice of Intent; a **copy** of this form; and the city/town fee payment.

To MassDEP Regional Office (see Instructions): Send a copy of the Notice of Intent or Abbreviated Notice of Intent; a **copy** of this form; and a **copy** of the state fee payment. (E-filers of Notices of Intent may submit these electronically.)

Date 04/03/24 FRALDARMOR+

Order of Town of Fairhaven \$ 67.50/100

sixty-seven dollars and fifty cents Dollars

Bank 5

For NOI Wetland Fee Transmittal Form Katie Medeiros

Harland Clarke ISLAND BREEZES®

KATIE A MEDEIROS
27 NAKATA AVE
FAIRHAVEN, MA 027192011

105
63-703/2113

Date 4/3/24 FRALDARMOR+

Pay to the Order of Town of Fairhaven \$ 150.00/100

one hundred fifty Dollars

Bank 5

For NOI Fee Katie Medeiros

Harland Clarke ISLAND BREEZES®

Date 4-3-24 FRALDARMOR+

Pay to the Order of Town of Fairhaven \$ 75.00/100

KATIE A MEDEIROS
27 NAKATA AVE
FAIRHAVEN, MA 027192011

103
63-703/2113

Date 04/03/24 FRALDARMOR+

Pay to the Order of Commonwealth of Massachusetts \$ 42.50/100

forty-two dollars and fifty cents Dollars Photo Safe Deposit Details on back

Bank 5

For NOI Wetland Fee Transmittal Form Katie Medeiros

Harland Clarke ISLAND BREEZES®



Town of Fairhaven
 Massachusetts
 BOARD OF ASSESSORS
 40 Center Street
 Fairhaven, MA 02719

RECEIVED
 BOARD OF ASSESSORS

APR 3 - 2024

FAIRHAVEN, MA

Ronnie Manzone, Chair
 Pamela K. Davis, MAA, Member
 Daniel Lane, Member

Joanne Correia, Principal Assessor
 Phone: (508) 979-4023, x-8111
 Facsimile: (508) 979-4079
 Email: jcorreia@fairhaven-ma.gov

ABUTTERS LIST REQUEST FORM

A \$25.00 Fee per request is required for preparation of the list. Payment is due at the time of submission of this form. Please allow 10 days from the submission of the form for the Assessors' office to complete the processing of your request. In conformance with MGL c40A §11, this information is needed so that an official abutters list as required, is used in notifying the abutters.

Date of Request: 4 / 3 / 24

Assessors Parcel ID: MAP 43 LOT 120

Property Address: 27 Nakata Avenue

Distance Required from Parcel # listed above (Circle One): 500 300 100
 (Note: if a distance is not circled, we cannot process your request)

Property Owner: Katie Medeiros

Property Owner's Mailing Address: 27 Nakata Ave

Town/City: Fairhaven State: MA Zip: 02719

Property Owner's Telephone # 774 - 328 - 1929

Requestor's Name (if different from Owner) _____

Requestor's Address: _____

Requestor's Telephone # _____ - _____ - _____

Requestor's Email: oceanskatie@gmail.com

Office Use Only: Date Fee Paid 4/3/24 Paid in Cash \$ _____

Paid by Check \$ 25.00 Check # 102 Town Receipt # _____



04/04/2024

8:39:44 AM

Fairhaven

GIS - Abutters

27 NAKATA AVE 100 FT

Parcel ID - Map/Block/Lot	Location	Owner/Mailing Address
43-118	31 NAKATA AVE Fairhaven, MA 02719	BUCCHANIO ANDREAL L C/O ANDREA LENNOX 35 VALLEY STREET BLACKSTONE, MA 01504
43-119	29 NAKATA AVE Fairhaven, MA 02719	HALABI JOSEPH TTE 473 WASHINGTON ST ATTLEBORO, MA 02703
43-120	27 NAKATA AVE Fairhaven, MA 02719	MOURA GALE E 27 NAKATA AVENUE FAIRHAVEN, MA 02719
43-121A	25 NAKATA AVE Fairhaven, MA 02719	SURPRENANT MARYANNE C/O GLENN RODRIGUES 111 BRIGHAM STREET NEW BDFORD, MA 02740
43-122	21 NAKATA AVE Fairhaven, MA 02719	THIRD GENERATION LLC C/O SUSAN SOL 141 NESTLES LANE ACUSHNET, MA 02743
43-201D	SCONTICUT NECK RD Fairhaven, MA 02719	VINJERUD LARS II TRUSTEE 20 BLACKMER STREET NEW BEDFORD, MA 02744
43-244	32 NAKATA AVE Fairhaven, MA 02719	VINJERUD LARS II TRUSTEE 20 BLACKMER STREET NEW BEDFORD, MA 02744
43-245	NAKATA AVE Fairhaven, MA 02719	FAIRHAVEN CONSERVATION COMMISSION 40 CENTER STREET FAIRHAVEN, MA 02719

**Notification to Abutters Under the
Massachusetts Wetlands Protection Act
and the Fairhaven Wetlands Bylaw**

*(this form must be completed and copies sent by certified mail
or hand delivery to all abutters within 100 feet of the property
where the project is located)*

In accordance with the Massachusetts General Laws Chapter 131, Section 40 (the Wetlands Protection Act) and the Fairhaven Wetlands Bylaw (Chapter 192), you are hereby notified of the following:

1. The applicant's name is Katie Medeiros

2. The applicant has filed the following with the Fairhaven Conservation Commission:
 Request for Determination of Applicability
 Notice of Intent
 Request to Amend an existing Order of Conditions
 Notice of Resource Area Delineation

3. The address or location of the site where the activity, project, or delineation is proposed is:
27 Nakata Avenue, Fairhaven, MA.

4. The proposed work includes retroactive application for concrete repair patch on patio,
replace existing deck, restore grass area of yard to grade with loam,
convert driveway to crushed shell, install 75ft of shadowbox style fence,
repair 50ft of existing post and beam fence

5. Copies of the above application may be examined at the Conservation Office, located in Town Hall, 40 Center Street, Fairhaven, MA 02719, between 9:00 AM and 4:00 PM, Monday through Friday. Copies may be obtained at the office if notified in advance or from the applicant.

6. Applications will also be uploaded to www.fairhaven-ma.gov/conservation-commission/pages/current-filings. If you are unable to access or view the application electronically, please contact the Conservation Office at 508-979-4023, ext. 128.

7. Notice of the public hearing including its date, time, and place will be published at least five business days in advance in the Fairhaven Neighborhood News, and will be posted on the Fairhaven Town Website and at the Fairhaven Town Hall not less than 48 hours in advance.

PLEASE NOTE:

Since you are receiving this notice, you may have wetland resource areas or wetland buffers on your property. Therefore, construction, cutting, clearing, or grading may require a permit. For clarification or for more information, call the Conservation Agent at 508-979-4082 or visit our website.

9589 0710 5270 1042 8471 24

U.S. Postal Service™
CERTIFIED MAIL® RECEIPT
 Domestic Mail Only

For delivery information, visit our website at www.usps.com®.

NEW BEDFORD, MA 02740

OFFICIAL USE

Certified Mail Fee	\$4.40	0719 03
	\$3.65	
Extra Services & Fees (check box, add fee as appropriate)		
<input type="checkbox"/> Return Receipt (hardcopy)	\$0.00	
<input type="checkbox"/> Return Receipt (electronic)	\$0.00	
<input type="checkbox"/> Certified Mail Restricted Delivery	\$0.00	
<input type="checkbox"/> Adult Signature Required	\$0.00	
<input type="checkbox"/> Adult Signature Restricted Delivery	\$0.00	
Postage	\$1.68	
Total Postage and Fees	\$8.73	

Sent To
 Lars Vingerud
 Street and Apt. No., or PO Box No.
 City, State, ZIP+4®

PS Form 3800, January 2023 PSN 7530-02-000-9047 See Reverse for Instructions

9589 0710 5270 1042 8471 62

U.S. Postal Service™
CERTIFIED MAIL® RECEIPT
 Domestic Mail Only

For delivery information, visit our website at www.usps.com®.

New Bedford, MA 02740

OFFICIAL USE

Certified Mail Fee	\$4.40	0719 03
	\$3.65	
Extra Services & Fees (check box, add fee as appropriate)		
<input type="checkbox"/> Return Receipt (hardcopy)	\$0.00	
<input type="checkbox"/> Return Receipt (electronic)	\$0.00	
<input type="checkbox"/> Certified Mail Restricted Delivery	\$0.00	
<input type="checkbox"/> Adult Signature Required	\$0.00	
<input type="checkbox"/> Adult Signature Restricted Delivery	\$0.00	
Postage	\$0.68	
Total Postage and Fees	\$8.73	

Sent To
 Maryanne Suprenant
 Street and Apt. No., or PO Box No.
 City, State, ZIP+4®

PS Form 3800, January 2023 PSN 7530-02-000-9047 See Reverse for Instructions

9589 0710 5270 1042 8471 48

U.S. Postal Service™
CERTIFIED MAIL® RECEIPT
 Domestic Mail Only

For delivery information, visit our website at www.usps.com®.

Fairhaven, MA 02740

OFFICIAL USE

Certified Mail Fee	\$4.40	0719 03
	\$3.65	
Extra Services & Fees (check box, add fee as appropriate)		
<input type="checkbox"/> Return Receipt (hardcopy)	\$0.00	
<input type="checkbox"/> Return Receipt (electronic)	\$0.00	
<input type="checkbox"/> Certified Mail Restricted Delivery	\$0.00	
<input type="checkbox"/> Adult Signature Required	\$0.00	
<input type="checkbox"/> Adult Signature Restricted Delivery	\$0.00	
Postage	\$0.68	
Total Postage and Fees	\$8.73	

Sent To
 Andrea Buccanico
 Street and Apt. No., or PO Box No.
 City, State, ZIP+4®

PS Form 3800, January 2023 PSN 7530-02-000-9047 See Reverse for Instructions

9589 0710 5270 1042 8470 94

U.S. Postal Service™
CERTIFIED MAIL® RECEIPT
 Domestic Mail Only

For delivery information, visit our website at www.usps.com®.

Attleboro, MA 02703

OFFICIAL USE

Certified Mail Fee	\$4.40	0719 03
	\$3.65	
Extra Services & Fees (check box, add fee as appropriate)		
<input type="checkbox"/> Return Receipt (hardcopy)	\$0.00	
<input type="checkbox"/> Return Receipt (electronic)	\$0.00	
<input type="checkbox"/> Certified Mail Restricted Delivery	\$0.00	
<input type="checkbox"/> Adult Signature Required	\$0.00	
<input type="checkbox"/> Adult Signature Restricted Delivery	\$0.00	
Postage	\$0.68	
Total Postage and Fees	\$8.73	

Sent To
 Halabi
 Street and Apt. No., or PO Box No.
 City, State, ZIP+4®

PS Form 3800, January 2023 PSN 7530-02-000-9047 See Reverse for Instructions

9589 0710 5270 1042 8471 79

U.S. Postal Service™
CERTIFIED MAIL® RECEIPT
 Domestic Mail Only

For delivery information, visit our website at www.usps.com®.

Fairhaven, MA 02740

OFFICIAL USE

Certified Mail Fee	\$4.40	0719 03
	\$3.65	
Extra Services & Fees (check box, add fee as appropriate)		
<input type="checkbox"/> Return Receipt (hardcopy)	\$0.00	
<input type="checkbox"/> Return Receipt (electronic)	\$0.00	
<input type="checkbox"/> Certified Mail Restricted Delivery	\$0.00	
<input type="checkbox"/> Adult Signature Required	\$0.00	
<input type="checkbox"/> Adult Signature Restricted Delivery	\$0.00	
Postage	\$0.68	
Total Postage and Fees	\$8.73	

Sent To
 Susan Sol
 Street and Apt. No., or PO Box No.
 City, State, ZIP+4®

PS Form 3800, January 2023 PSN 7530-02-000-9047 See Reverse for Instructions

9589 0710 5270 1042 8471 31

U.S. Postal Service™
CERTIFIED MAIL® RECEIPT
 Domestic Mail Only

For delivery information, visit our website at www.usps.com®.

Fairhaven, MA 02740

OFFICIAL USE

Certified Mail Fee	\$4.40	0719 03
	\$3.65	
Extra Services & Fees (check box, add fee as appropriate)		
<input type="checkbox"/> Return Receipt (hardcopy)	\$0.00	
<input type="checkbox"/> Return Receipt (electronic)	\$0.00	
<input type="checkbox"/> Certified Mail Restricted Delivery	\$0.00	
<input type="checkbox"/> Adult Signature Required	\$0.00	
<input type="checkbox"/> Adult Signature Restricted Delivery	\$0.00	
Postage	\$0.68	
Total Postage and Fees	\$8.73	

Sent To
 Fairhaven Conservation Commission
 Street and Apt. No., or PO Box No.
 City, State, ZIP+4®

PS Form 3800, January 2023 PSN 7530-02-000-9047 See Reverse for Instructions

PLAN FOR NO1 APPLICATION

Prepared By: Katie Medeiros

04-03-24

MAP 43 LOT 120 - 27 NAKATA AVE

*NOT DRAWN TO SCALE



BUZZARDS BAY

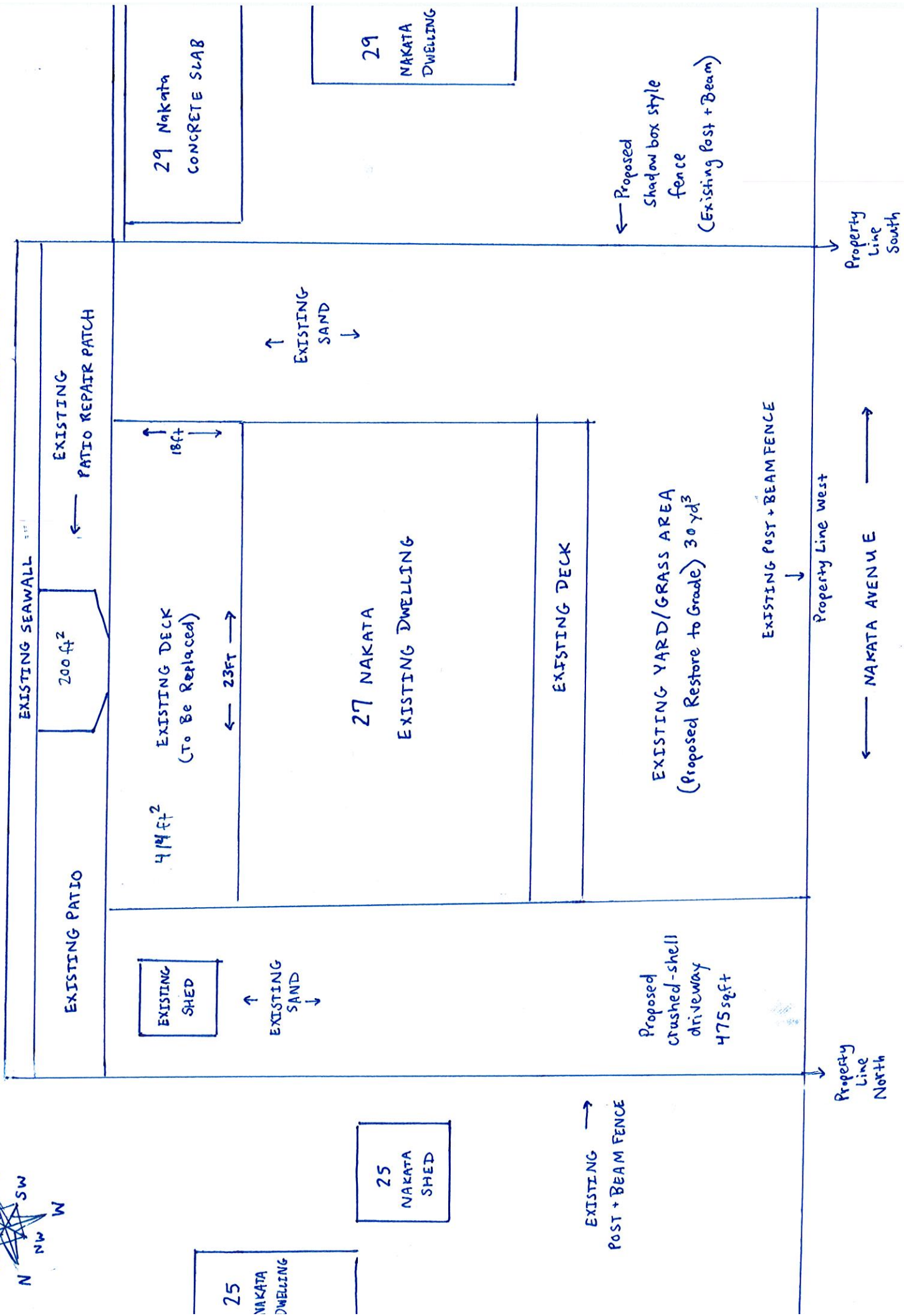

29 NAKATA
CONCRETE SLAB

29
NAKATA
DWELLING

← Proposed
Shadow box style
fence
(Existing post + Beam)

Property
Line
South

EXISTING
PATIO REPAIR PATCH

↑
EXISTING
SAND
↓

↑
18ft
↓

414 ft²
EXISTING DECK
(To Be Replaced)

← 23FT →

27 NAKATA
EXISTING DWELLING

EXISTING DECK

EXISTING YARD/GRASS AREA
(Proposed Restore to Grade) 30 yd³

EXISTING POST + BEAM FENCE

Property Line West

← NAKATA AVENUE →

EXISTING
SHED

↑
EXISTING
SAND
↓

Proposed
crushed-shell
driveway
475 sqft

25
NAKATA
SHED

EXISTING →
POST + BEAM FENCE

Property
Line
North

25
NAKATA
DWELLING

27 Nakata Avenue
Plan for NOI Application
04/09/2024
By Katie Medeiros

Legend



50 ft

Google Earth

Image © 2024 Airbus