

- GENERAL NOTES:
- RESULTS OF TOPOGRAPHIC SURVEY PERFORMED BY FOTH INFRASTRUCTURE AND ENVIRONMENT, LLC ON MARCH 23, 2022. REPRESENT EXISTING SITE CONDITIONS.
  - RESULTS OF HYDROGRAPHIC SURVEY PERFORMED BY FOTH INFRASTRUCTURE AND ENVIRONMENT IN NOVEMBER 2018 & MARCH 2021.
  - VERTICAL DATUM IS IN NAVD88. VERTICAL DATUM CONVERSIONS ARE PROVIDED BY THE USACE IN MEMO DATED 2/18/15 BY JACOBS AND NOAA TIDAL STATION "CLARKS POINT" #8447712, TIDAL EPOCH 1983-2001.
  - PROJECT SITE IS IN FEMA ZONE AE 6 IN NAVD88 IN ACCORDANCE TO FEMA FIRM #25005C0393G, EFFECTIVE DATE JULY 16, 2014.
  - PROPERTY LINES SHOWN REPRESENT THE LATEST FROM KENNETH R. FERREIRA ENGINEERING, PLAN "SUPPLEMENTAL WORKSHEET TO ACCOMPANY APPROVAL NOT REQUIRED PLAN OF LAND, 8 WINSLOW COURT" DATED DECEMBER 10, 2014 AND REVISED JULY 19, 2016.
  - NHESP LINES, SHELLFISH SUITABILITY AREA LINES, DESIGNATED PORT AREA LINE, AND HISTORIC HIGH TIDE LINE REPRESENT THE LATEST FROM THE DATABASE INFORMATION BASED ON MA GIS AS OF MARCH 24, 2022.
  - THE INFORMATION DEPICTED ON THIS PLAN REPRESENTS THE RESULTS OF SURVEYS ON THE DATES SHOWN, AND CAN ONLY BE CONSIDERED AS INDICATING THE GENERAL CONDITIONS AT THAT TIME. INTERPOLATED INFORMATION FROM BETWEEN SOUNDING RUNS IS NOT GUARANTEED. SHOALS, OBSTRUCTIONS OR OTHER DIFFERING CONDITIONS MAY EXIST BETWEEN THESE RUNS. CONSULT WITH FOTH ENVIRONMENT AND ENGINEERING FOR MORE DETAILED INFORMATION.
  - POSSESSION AND USE OF THE MATERIAL CONTAINED ON THESE DRAWINGS IS GRANTED ONLY IN CONNECTION WITH ITS USE AS IT RELATES TO THE TITLED PROJECT. ANY OTHER USE, REPRODUCTION OR DISCLOSURE OF THE INFORMATION CONTAINED HEREON IS EXPRESSLY PROHIBITED WITHOUT THE WRITTEN CONSENT OF FOTH.
  - WORK SHOWN AS PROPOSED WORK OUTSIDE OF THE SCOPE OF THIS NOTICE OF INTENT APPLICATION SHALL BE PERMITTED THROUGH THE STATE ENHANCED REMEDY PROCESS UNDER SUPERVISION OF MASSDEP AND USEPA.
  - PROJECT COMPONENTS INCLUDED UNDER THE SER REVIEW INCLUDE THE PROPOSED DREDGE TEMPLATE.

© COPYRIGHT 2022, FOTH INFRASTRUCTURE & ENVIRONMENT, LLC

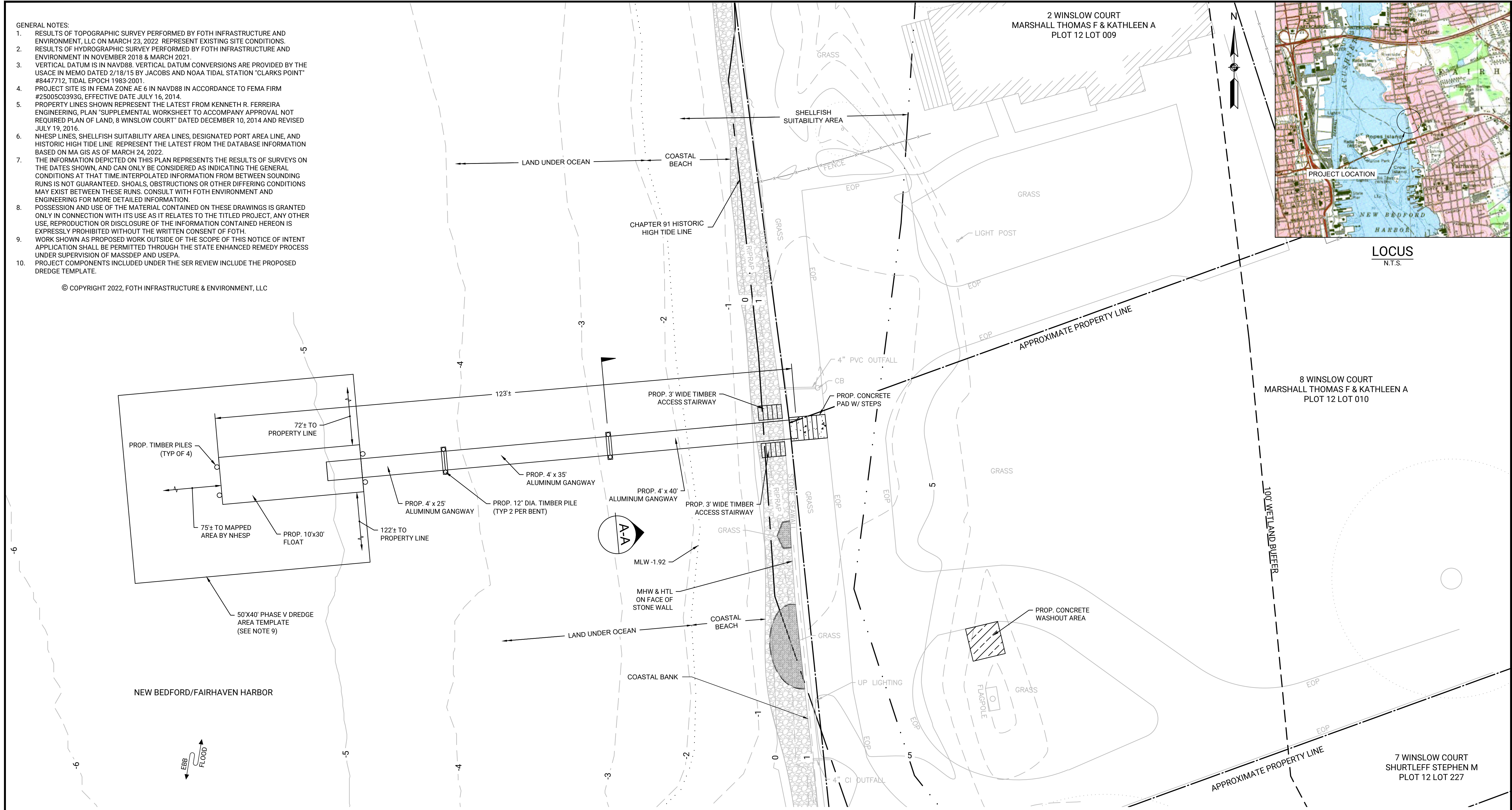

**SITE PLAN VIEW**  
SCALE: 1" = 10'

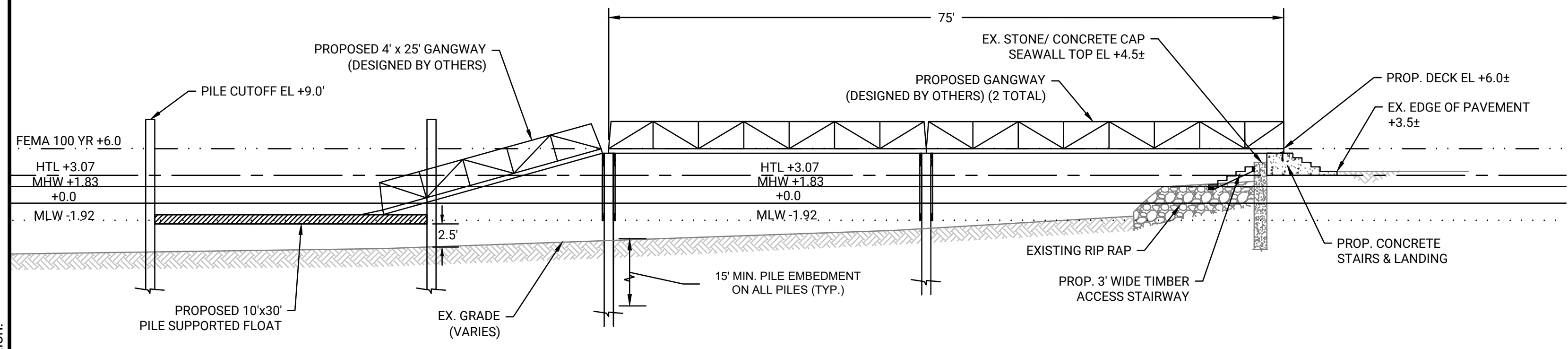

**PROFILE VIEW GANGWAY AND FLOAT**  
SCALE: 1" = 10'

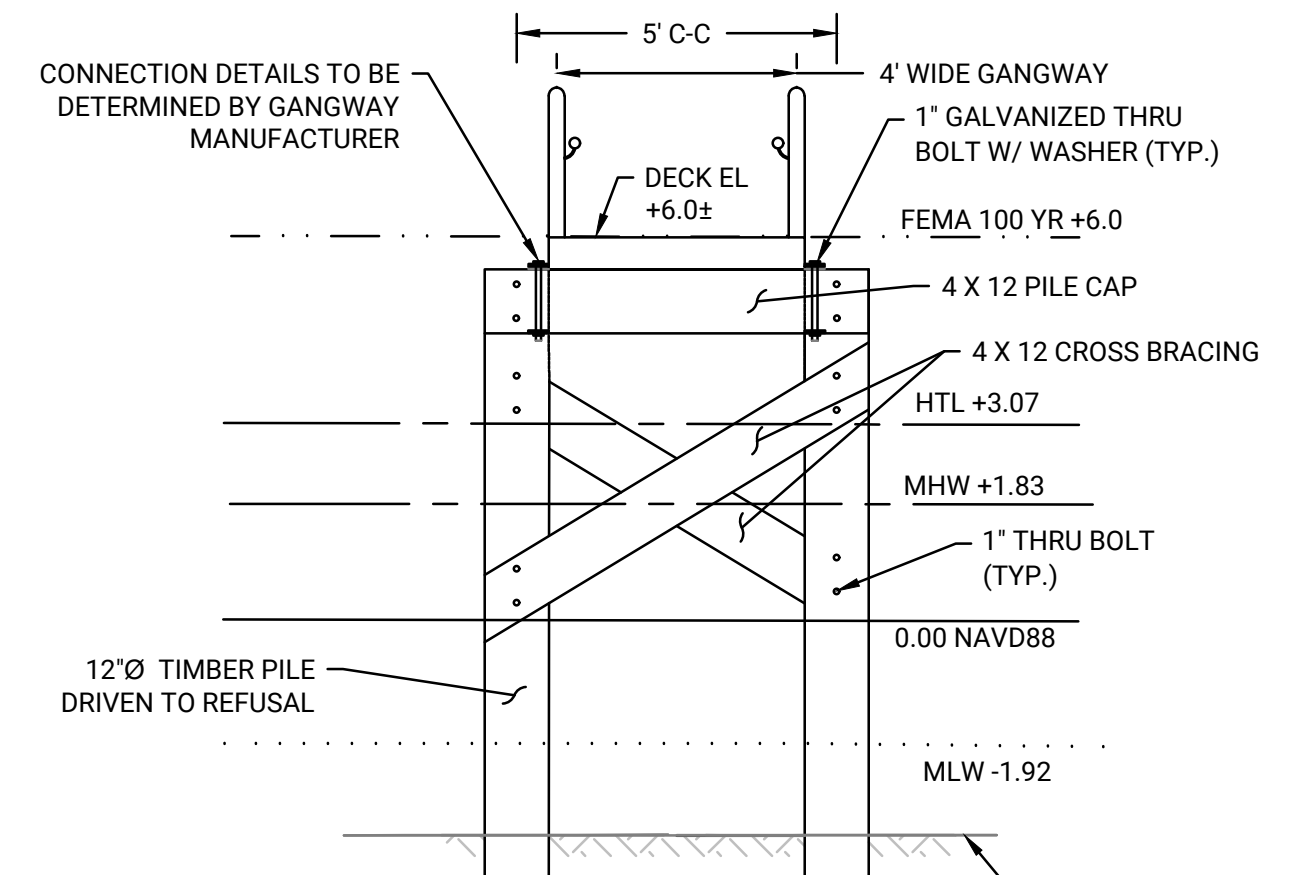

**TYPICAL SECTION A-A**  
SCALE: 1" = 3'

- LEGEND:**
- MLW (-1.79)
  - ELEVATION CONTOURS
  - 100' WETLAND BUFFER ZONE
  - SHELLFISH SUITABILITY AREA
  - CHAPTER 91 HISTORIC HIGH TIDE LINE

**DATUM OFFSETS**

MLLW	NAVD 88	HTL	MHW	MLW
4.85	3.07	HTL		
3.75	1.83	MHW		
1.92	0.00			
1.10	-0.82			NGVD29
0.00	-1.92			MLW

OFFSETS PROVIDED BY THE USACE IN MEMO DATED 2/18/15 BY JACOBS AND NOAA TIDAL STATION "CLARKS POINT" #8447712 TIDAL EPOCH 1983-2001

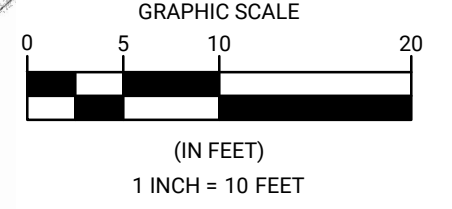

**LOCUS**  
N.T.S.

**THOMAS MARSHALL  
8 WINSLOW COURT, FAIRHAVEN MA  
PROPOSED FIXED PIER & FLOATING DOCK**

**REVISIONS**

NO.	DATE	DESCRIPTION
XX	XX	XX
XX	XX	XX
XX	XX	XX
XX	XX	XX
XX	XX	XX
XX	XX	XX

**DATE OF PREPARATION**

BY	DATE
AHM	03/23/2022
AMH	03/25/2022
PSR	03/25/2022
SEN	04/11/2022

**SHEET TITLE:**  
**SITE PLAN**

**ISSUANCE:**  
PROJECT NO: 0022M039.00  
SHEET NUMBER  
**C-100**

